

- NOTES**
1. Verifying Dimensions. Dimensions shall be verified against such other drawings or site conditions as pertain to this part of the work.
 2. Existing Services. Any information concerning the location of existing services indicated on this drawing is intended for general guidance only.
 3. Datum. Ordnance Datum Malin (unless noted otherwise).
 4. ESB refers to Electricity Service Board. CD refers to Chart Datum. OD refers to Ordnance Datum Malin.
 5. For section locations refer to CP1901-3FM-RPS-S45-04-DR-C-0403 to 0406.
 6. Proposed Drainage Layout refer to CP1901-3FM-RPS-S45-04-DR-C-0418 to 0421.
 7. Proposed Surfacing Details CP1901-3FM-RPS-S45-04-DR-C-0414 to 0417.
 8. Proposed Surface Levels CP1901-3FM-RPS-S45-04-DR-C-0424 to 0427.
 9. Building Details refer to CP1901-3FM-RPS-S45-04-DR-C-0450 to 0455.
 10. Refer to Highways Engineering (HE) Series drawings for External Road Network details.
- Planning Boundary under this application

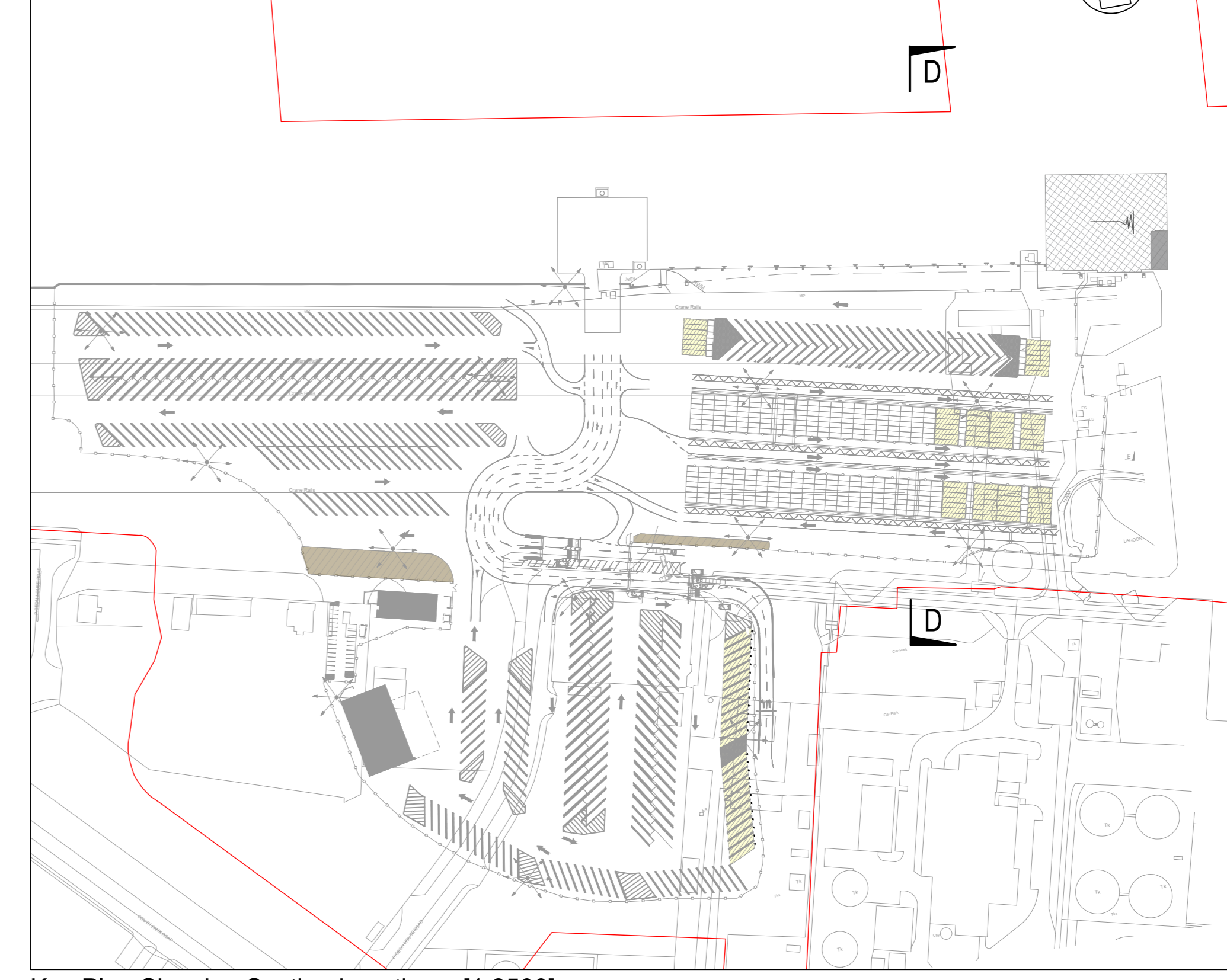

Key Plan Showing Section Locations [1:2500]

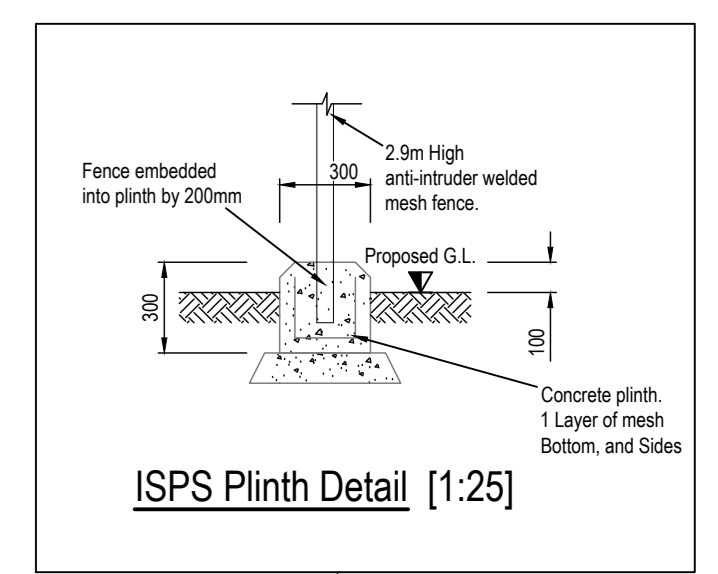
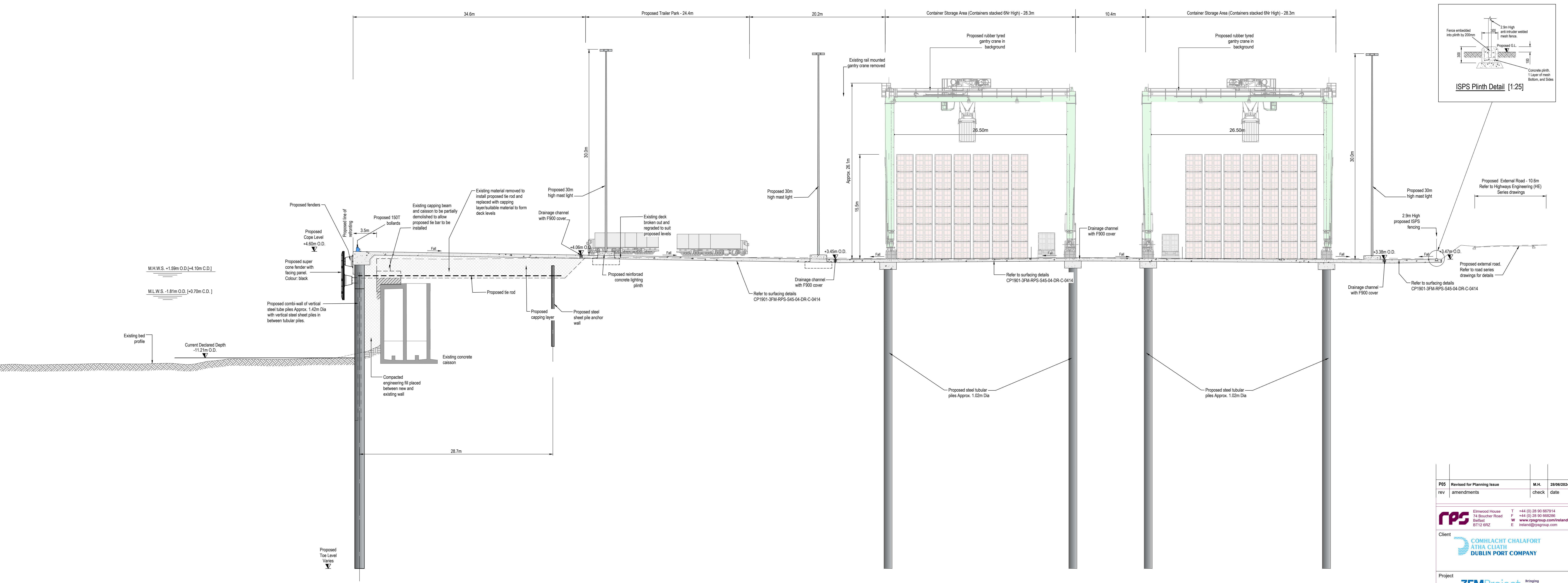

ISPS Plinth Detail [1:25]

Section D-D [1:200]

P05	Revised for Planning Issue	M.H.	28/06/2024
rev	amendments	check	date

Elmwood House
 74 Boucher Road
 Belfast
 BT1 2 6SC
 T +44 (0) 28 30 667314
 F +44 (0) 28 30 666286
 W www.rpsgroup.com/ireland
 E ireland@rpsgroup.com

Client

Project

Title
 Ro-Ro Terminal (Area K)
 Proposed Cross Section D-D

Project Number	Sheet Size	Drawing Scale
IBM0842	A0	As Shown

Drawing Number
 CP1901-3FM-RPS-S45-04-DR-C-0408

Drawn By	Status	Revision
M.H.	S4	P05

Checked By	Approved By	Date
E.H.	M.McC.	19/12/2022