

NOTES

1. Verifying Dimensions. Dimensions shall be verified against such other drawings or site conditions as pertain to this part of the work.
2. Existing Services. Any information concerning the location of existing services indicated on this drawing is intended for general guidance only.
3. Datum. Ordnance Datum Malin (unless noted otherwise)
4. ESS refers to Electricity Service Board
 CD refers to Chart Datum
 OD refers to Ordnance Datum Malin
5. For section locations refer to CP1901-3FM-RPS-S45-04-DR-C-0403 to 0406
6. Proposed Drainage Layout refer to CP1901-3FM-RPS-S45-04-DR-C-0418 to 0421
7. Proposed Surfacing Details CP1901-3FM-RPS-S45-04-DR-C-0414 to 0417
8. Proposed Surface Levels CP1901-3FM-RPS-S45-04-DR-C-0424 to 0427
9. Building Details refer to CP1901-3FM-RPS-S45-04-DR-C-0450 to 0455
10. Refer to Highways Engineering (HE) Series drawings for External Road Network details.

— Planning Boundary under this application

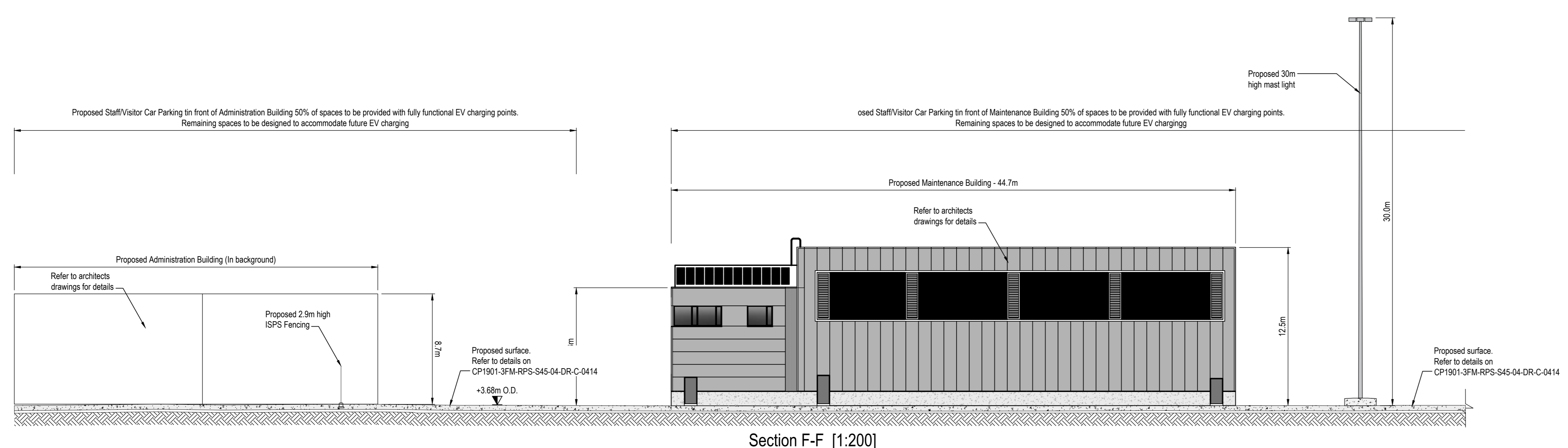

Section F-F [1:200]

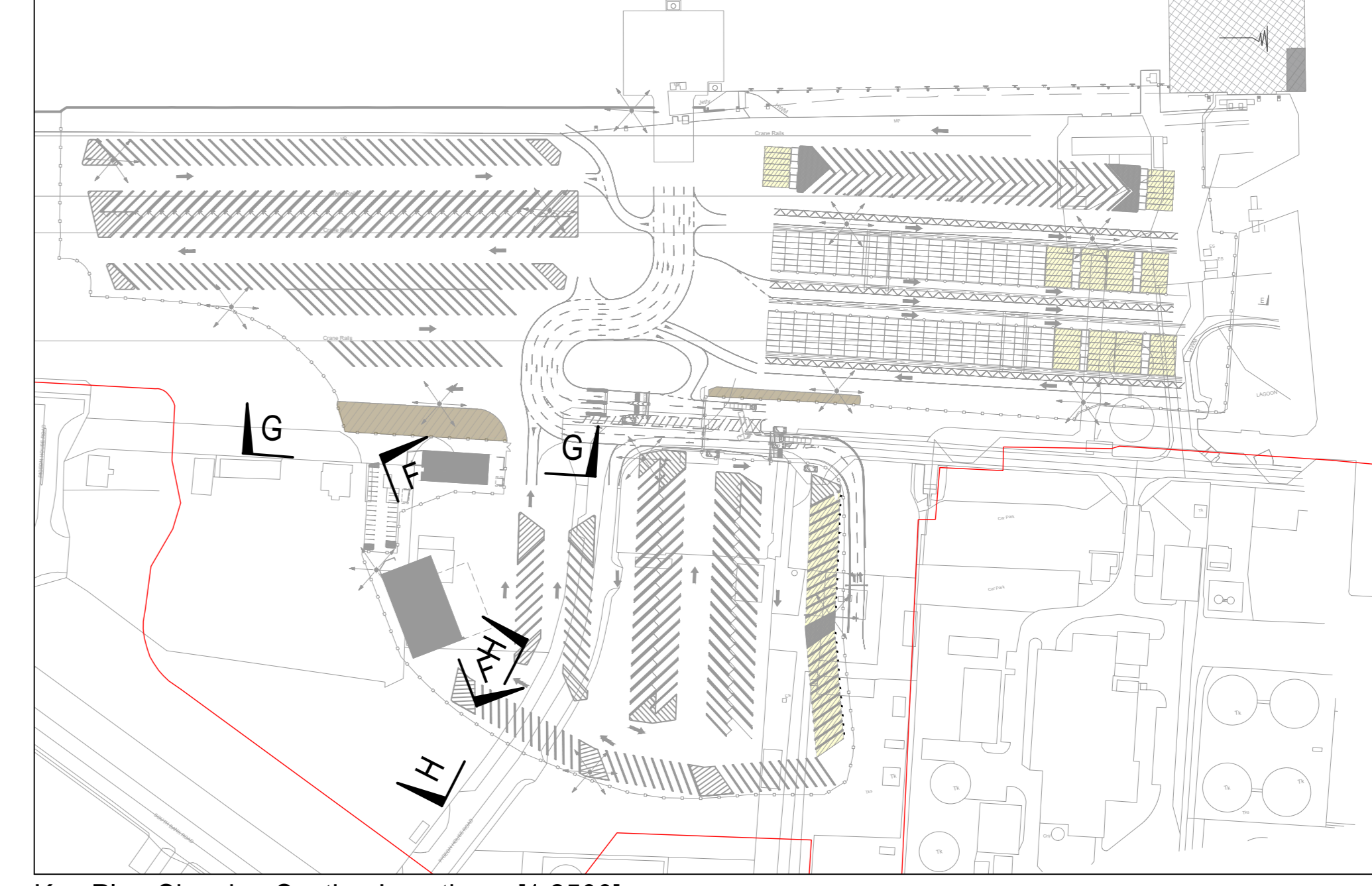

Key Plan Showing Section Locations [1:2500]

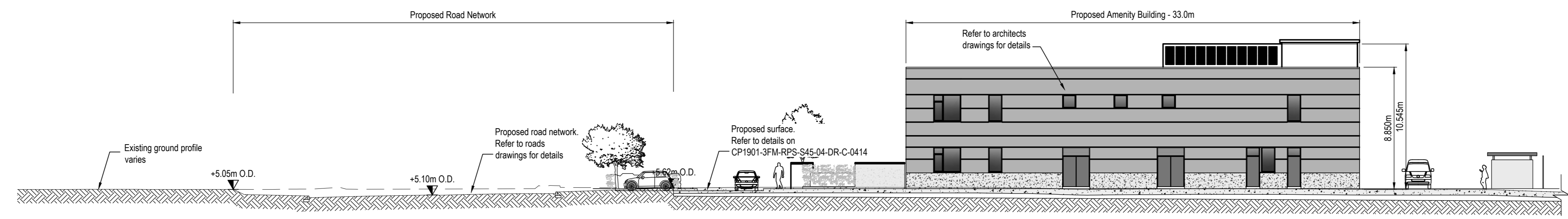

Section G-G [1:200]

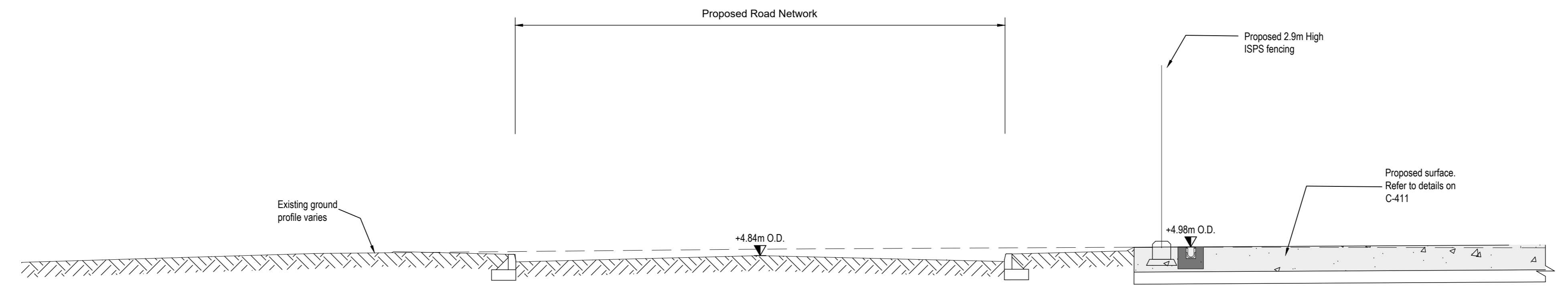

Section H-H [1:50]

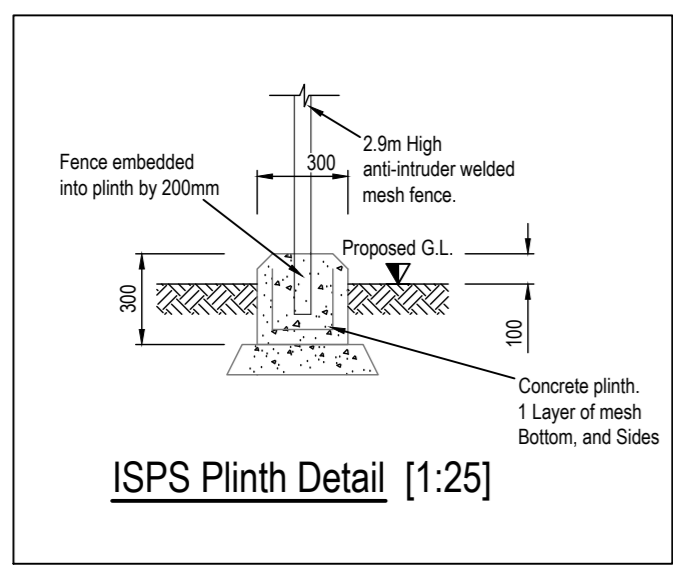

ISPS Plinth Detail [1:25]

P05	Revised for Planning Issue	M.H.	28/06/2024
rev	amendments	check	date
<p>Client: COMHLACHT CHALAFORT ATHA CLIAITH DUBLIN PORT COMPANY</p>			
<p>Project: 3FMProject <small>Integrating Dublin Port's Terminal</small></p>			
<p>Title: Ro-Ro Terminal (Area K) Proposed Cross Sections F G and H</p>			
Project Number	Sheet Size	Drawing Scale	
IBM0842	A0	As Shown	
Drawing Number			
CP1901-3FM-RPS-S45-04-DR-C-0410			
Drawn By	Status	Revision	
M.H.	S4	P05	
Checked By	Approved By	Date	
E.H.	M.M.C.	19/12/2022	