

Surfacing Key Plan showing Viewport Layout [1:3000]

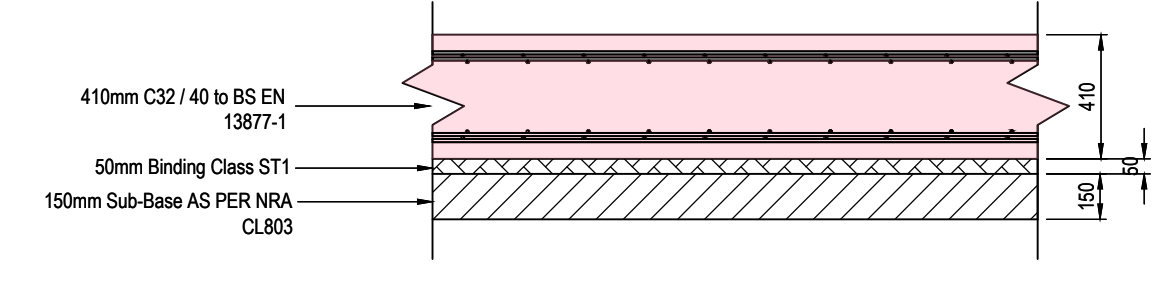

Area 1 - Container Stack Pavement Detail [1:25]

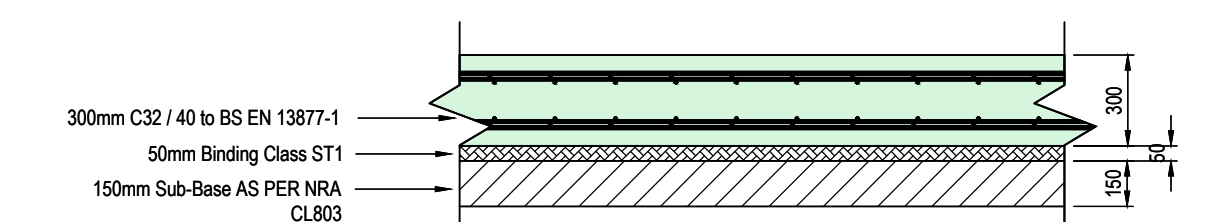

Area 2 - HGV/Tractor and Trailer Heavy Duty Pavement Detail - Option 1 Concrete [1:25]

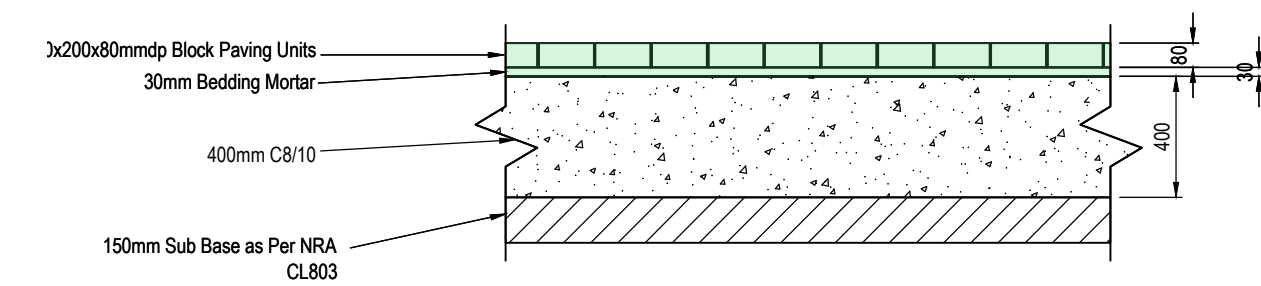

Area 2 - HGV/Tractor and Trailer Heavy Duty Pavement Detail - Option 2 Pavers [1:25]

- NOTES**
1. Verifying Dimensions. Dimensions shall be verified against such other drawings or site conditions as pertain to this part of the work.
  2. Existing Services. Any information concerning the location of existing services indicated on this drawing is intended for general guidance only.
  3. Datum. Ordinance Datum Malin (unless noted otherwise)
  4. ESS refers to Electricity Service Board. CD refers to Chart Datum. OD refers to Ordinance Datum Malin.
  5. Proposed Drainage Layout refer to CP1901-3FM-RPS-S45-04-DR-C-0418 to 0421
  6. Proposed Surface Levels. CP1901-3FM-RPS-S45-04-DR-C-0424 to 0427
  7. Refer to Highways Engineering (HE) Series drawings for External Road Network details.
- Area 1 Container Stack Pavement Type Heavy Duty Pavement
  - Area 2 HGV/Tractor and Trailer Heavy Duty Pavement
  - Existing Great South Wall. Areas retained as existing
  - Proposed Reinforced Concrete Linkspan
  - Proposed Reinforced Concrete Cope Beam
  - Proposed Buildings. Refer to CP1901-3FM-RPS-S45-04-DR-C-0450 to 0455 for details
  - Existing Cope Beam
  - Planning Boundary under this application

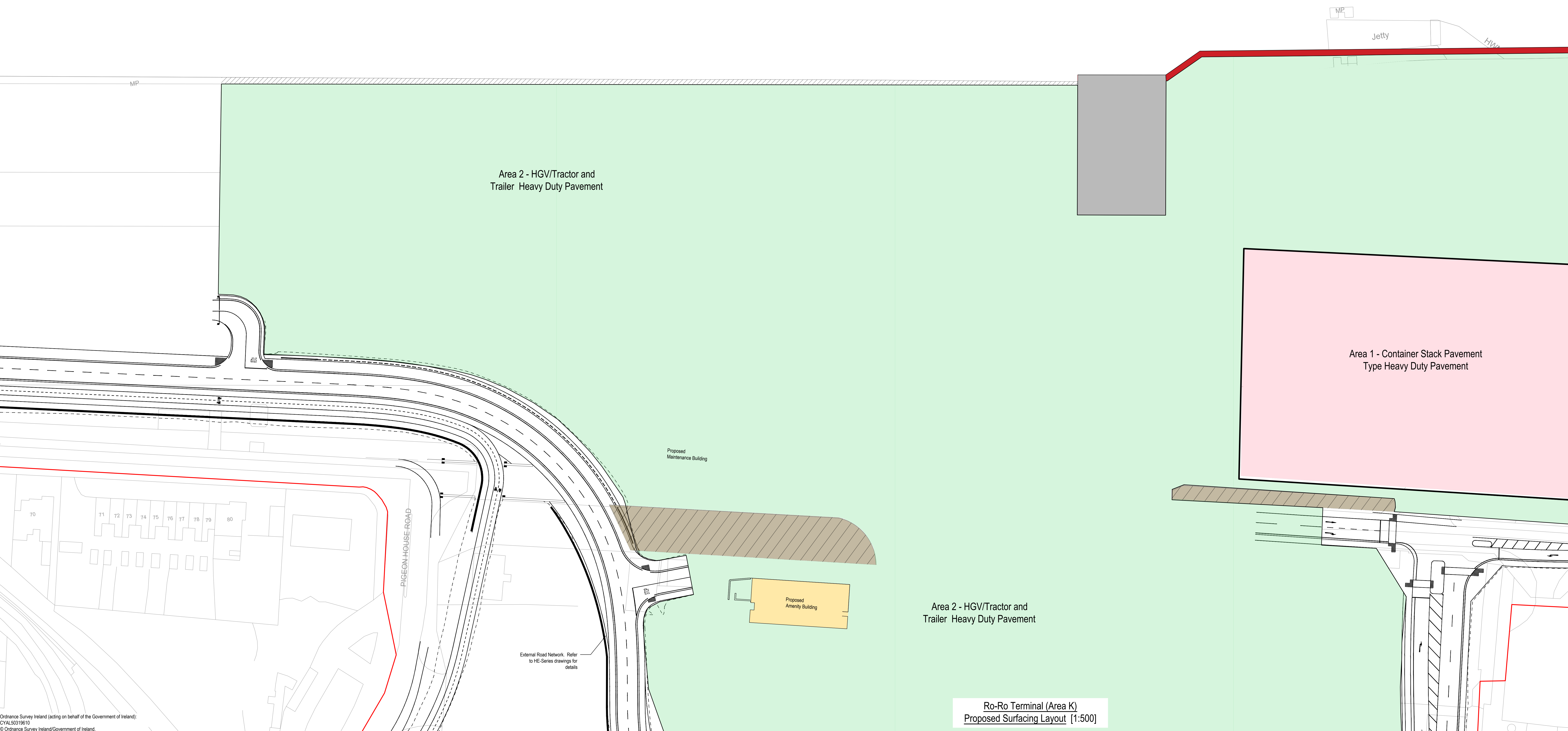

Ro-Ro Terminal (Area K) Proposed Surfacing Layout [1:500]

P01	Revised for Planning Issue	M.H.	28/06/2024
rev	amendments	check	date

Elmwood House T +44 (0) 28 90 667014  
 74 Boucher Road F +44 (0) 28 90 666286  
 Belfast B11 2 6JZ W www.rpsgroup.com/ireland  
 E ireland@rpsgroup.com

Client

Project

Title  
 Ro-Ro Terminal (Area K)  
 Proposed Surfacing Sheet 1

Project Number	Sheet Size	Drawing Scale
IBM0842	A0	As Shown

Drawing Number	Revision	
CP1901-3FM-RPS-S45-04-DR-C-0415	P01	

Drawn By	Status	Revision
M.H.	S4	P01

Checked By	Approved By	Date
E.H.	M.McC.	19/12/2022

Ordnance Survey Ireland (acting on behalf of the Government of Ireland):  
 CYAL5019610  
 © Ordnance Survey Ireland/Government of Ireland.