

Surfacing Key Plan showing Viewport Layout [1:3000]

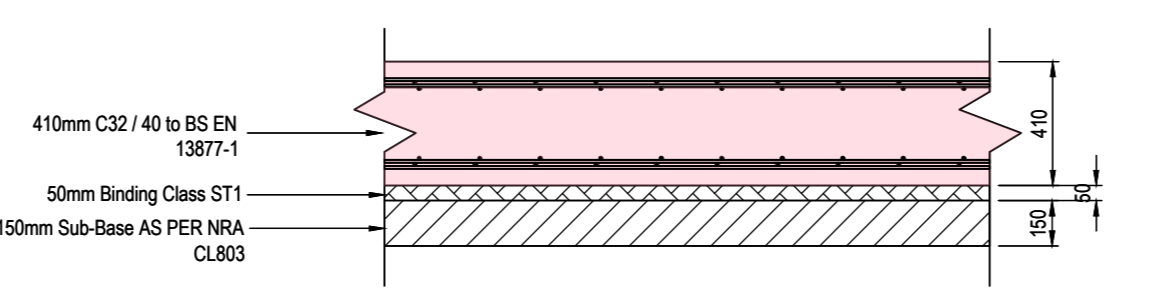

Area 1 - Container Stack Pavement Detail [1:25]

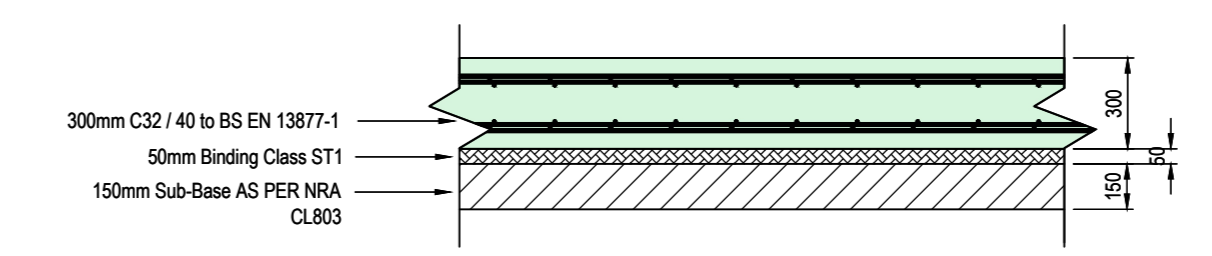

Area 2 - HGV/Tractor and Trailer Heavy Duty Pavement Detail - Option 1 Concrete [1:25]

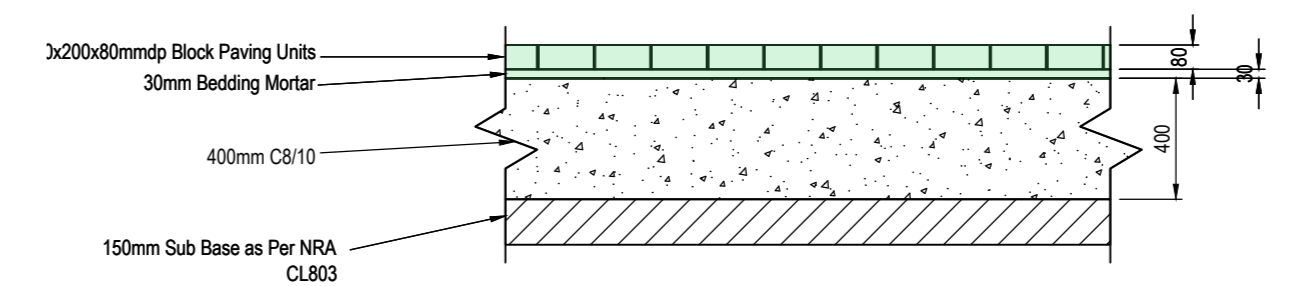

Area 2 - HGV/Tractor and Trailer Heavy Duty Pavement Detail - Option 2 Pavers [1:25]

- NOTES**
1. Verifying Dimensions. Dimensions shall be verified against such other drawings or site conditions as pertain to this part of the work.
  2. Existing Services. Any information concerning the location of existing services indicated on this drawing is intended for general guidance only.
  3. Datum. Ordnance Datum Malin (unless noted otherwise).
  4. ESSI refers to Electricity Service Board. CD refers to Chart Datum. OD refers to Ordnance Datum Malin.
  5. Proposed Drainage Layout refer to CP1901-3FM-RPS-S45-04-DR-C-0418 to 0421.
  6. Proposed Surface Levels. CP1901-3FM-RPS-S45-04-DR-C-0424 to 0427.
  7. Refer to Highways Engineering (HE) Series drawings for External Road Network details.
- Area 1 Container Stack Pavement Type Heavy Duty Pavement
  - Area 2 HGV/Tractor and Trailer Heavy Duty Pavement
  - Existing Great South Wall. Areas retained as existing
  - Proposed Reinforced Concrete Linkspan
  - Proposed Reinforced Concrete Cope Beam
  - Proposed Buildings. Refer to CP1901-3FM-RPS-S45-04-DR-C-0450 to 0455 for details
  - Existing Cope Beam
  - Planning Boundary under this application



Ro-Ro Terminal (Area K) Proposed Surfacing Layout [1:500]

P01	Revised for Planning Issue	M.H.	28/06/2024
rev	amendments	check	date
<p>Client: <b>COMHLACHT CHALAFORT ATHA CLIAITH DUBLIN PORT COMPANY</b></p>			
<p>Project: <b>3FMProject</b></p>			
<p>Title: <b>Ro-Ro Terminal (Area K) Proposed Surfacing Sheet 2</b></p>			
Project Number	Sheet Size	Drawing Scale	
IBM0842	A0	As Shown	
Drawing Number: CP1901-3FM-RPS-S45-04-DR-C-0416			
Drawn By	Status	Revision	
M.H.	S4	P01	
Checked By	Approved By	Date	
E.H.	M.McC.	19/12/2022	

Ordnance Survey Ireland (acting on behalf of the Government of Ireland): C1AL50139610 © Ordnance Survey Ireland/Government of Ireland.