

NOTES

1. Verifying Dimensions.
Dimensions shall be verified against such other drawings or site conditions as pertain to this part of the work.
2. Existing Services.
Any information concerning the location of existing services indicated on this drawing is intended for general guidance only.
3. Datum.
Ordnance Datum Malin (unless noted otherwise)
4. ESB refers to Electricity Service Board
CD refers to Chart Datum
OD refers to Ordnance Datum Malin
5. Refer to CP1901-3FM-RPS-S45-04-DR-C-0412 to 0415 for Surfacing
6. Refer to CP1901-3FM-RPS-S45-04-DR-C-0416 to 0420 for Drainage

- Planning Boundary under this application
- Proposed Surface Level (OD Malin)
- ↑ Proposed Slope Direction Arrow
- Proposed Drainage Channel
- - - Proposed Surface Ridge Line
- ϕ -3.50m Proposed External Road Level. Refer to HE Series Drawings for Details
- ϕ -3.60m Existing Surface Level based on Topographic Survey 2020 Ref: "MSL35753_T&OR_IG_2D"
- Existing Great South Wall Exclusion Zone
- Proposed Buildings. Refer to CP1901-3FM-RPS-S45-04-DR-C-0450 to 0455 for details

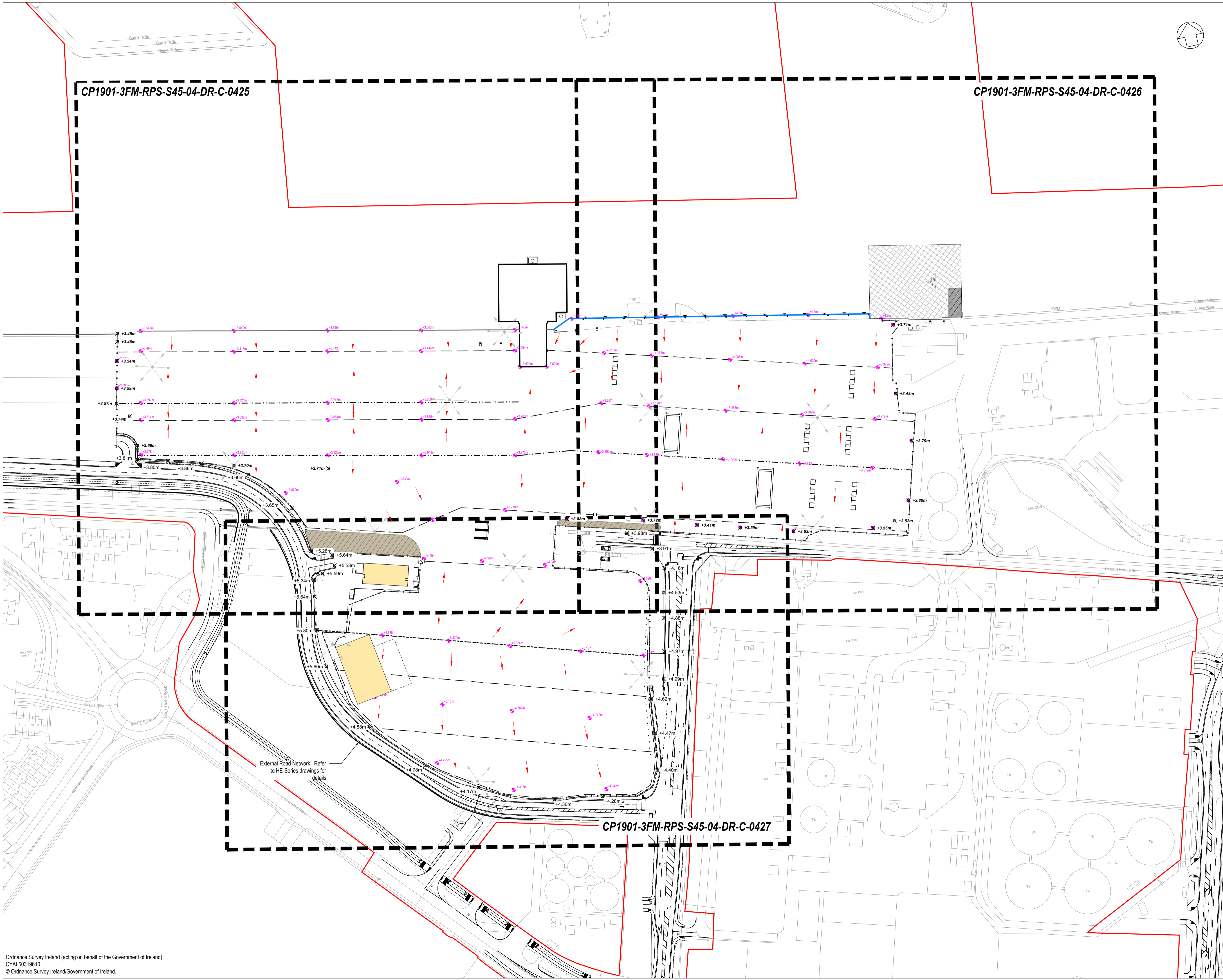

P01	Revised for Planning Issue	M.H.	28/06/2024
rev	amendments	check	date

rps Elmwood House
74 Boucher Road
Belfast
BT12 6RZ

T +44 (0) 28 90 667914
F +44 (0) 28 90 668286
W www.rpsgroup.com/ireland
E ireland@rpsgroup.com

Client

**COMHLACHT CHALAFORT
ATHA CLIATH
DUBLIN PORT COMPANY**

Project

3FMProject Bringing Dublin Port To 2040

Title

**Ro-Ro Terminal (Area K)
Proposed Surface Levels**

Project Number	Sheet Size	Drawing Scale
IBM0842	A1	1:1250

Drawing Number

CP1901-3FM-RPS-S45-04-DR-C-0424

Drawn By	Status	Revision
M.H.	S4	P01

Checked By	Approved By	Date
E.H.	M.McC.	20/07/2023