

NOTES

1. This document is the property of RPS. The design information contained herein is strictly confidential. This document is not to be used, reproduced, disclosed or circulated in whole or in part without the prior written permission in each instance of RPS.
2. Issue of Drawings. Hard copies, dwf and pdf will form a controlled issue of the drawing. All other formats (dwg, etc.) are deemed to be uncontrolled issue and any work carried out based on these files is at the recipient's own risk. RPS will not accept any responsibility for any errors arising from the use of these files, either by human error by the recipient, listing of un-dimensioned measurements, compatibility issues with the recipient's software, and any errors arising when these files are used to aid the recipient's drawing production, or setting out on site.

WASTEWATER NOTES:

1. ALL PUBLIC WASTEWATER DRAINAGE TO BE IN ACCORDANCE WITH UISCE EIREANN STANDARDS, NAMELY IW-CDS-5030-03 & IW-CDS-5030-01 AND IW-TEC-800-01
2. ALL PRIVATE WASTEWATER DRAINAGE TO BE IN ACCORDANCE WITH UISCE EIREANN STANDARDS AND BUILDING REGULATIONS PART H.
3. WASTEWATER PIPES TO BE CONSTRUCTED FROM MATERIAL CONFORMING WITH UISCE EIREANN IW-CDS-5030-03 SECTION 3.13 AND BUILDING REGULATIONS PART H SECTION 1.3.6.
4. STANDARD WASTEWATER MANHOLES TO BE IN ACCORDANCE WITH UISCE EIREANN STD-WW-10.
5. PRIVATE SIDE INSPECTION CHAMBERS TO BE AS PER UISCE EIREANN DETAIL STD-WW-13 AND BUILDING REGULATIONS PART H.
6. BACKDROP MANHOLES, WHERE REQUIRED, TO BE IN ACCORDANCE WITH UISCE EIREANN STD-WW-12.
7. SERVICE CONNECTIONS TO BE IN ACCORDANCE WITH UISCE EIREANN STD-WW-03 AND STD-WW-04.
8. LEVELS AND GRADIENTS OF ALL DIVERSIONS ARE INDICATIVE ONLY AND TO BE CONFIRMED ONCE EXISTING LEVELS ARE KNOWN.
9. SEE CP1901-3FM-RPS-S45-04-DR-C-0432 FOR RELEVANT WASTEWATER NETWORK STANDARD DETAILS.

AREA K LEGEND

- EXISTING WASTEWATER NETWORK (DPC OWNED) —○—
- EXISTING WASTEWATER NETWORK (UISCE EIREANN OWNED) —○—
- EXISTING WASTEWATER PIPE TO BE DECOMMISSIONED - - -
- PROPOSED DIVERTED UISCE EIREANN WASTEWATER PIPE - - -
- PROPOSED WASTEWATER GRAVITY PIPE - - -
- PROPOSED WASTEWATER MANHOLE/ACCESS CHAMBER ●
- PROPOSED WASTEWATER RISING MAIN FOR AREA N —
- PROPOSED WASTEWATER RISING MAIN FOR AREA L —
- RED LINE PLANNING BOUNDARY IN THIS APPLICATION —
- EXTENT OF AREA K - - -

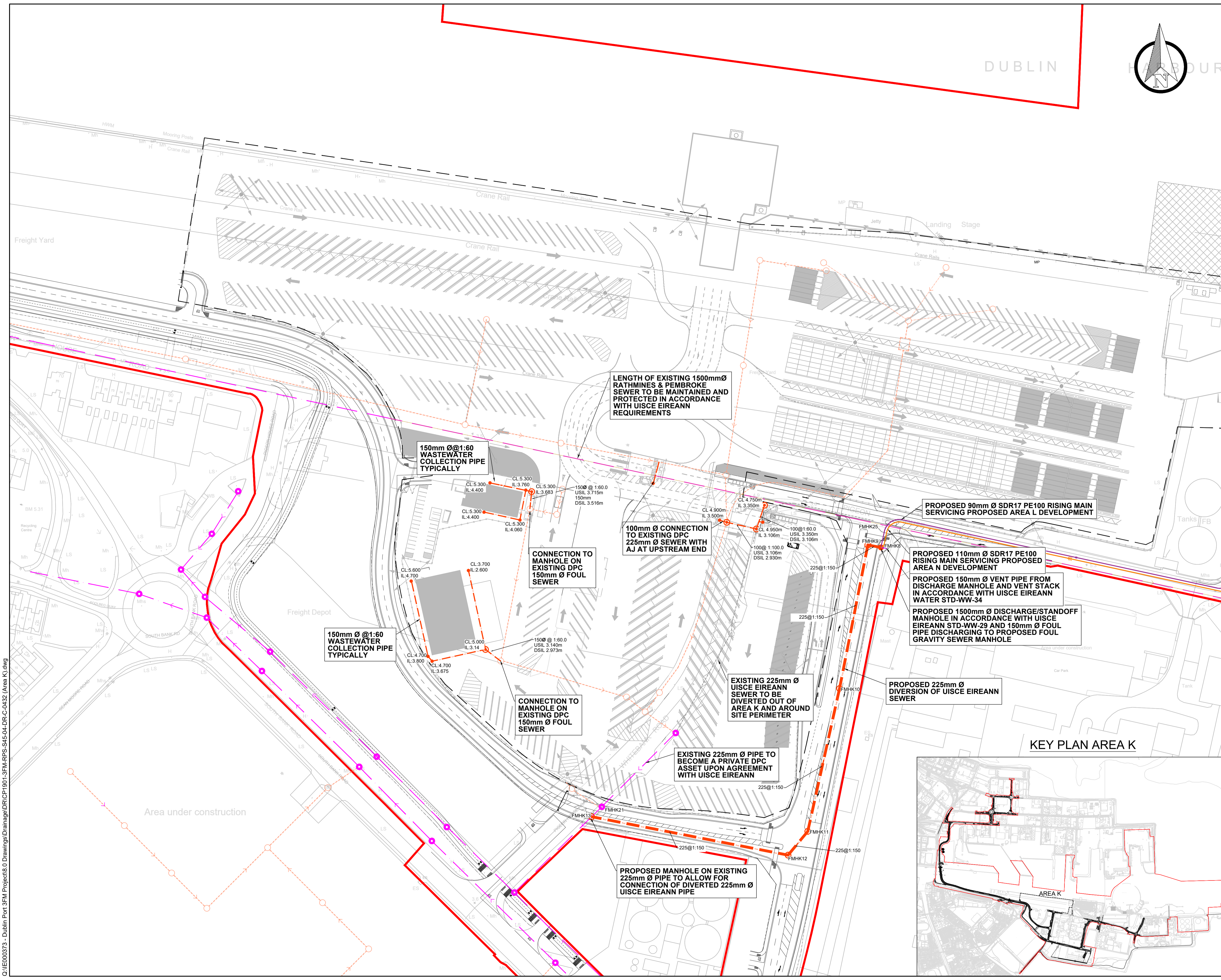

P03	27/08/24	DCI	REISSUED FOR PLANNING	✕
P02	31/08/24	DCI	REISSUED FOR PLANNING	✕
P01	18/10/23	DCI	ISSUE FOR PLANNING	✕
Rev	Date	Drn	Amendment / Issue	App



rps MAKING COMPLEX EASY
 Innishmore, Ballincollig, Co Cork, Ireland.
 T +353 21 4665900
 W www.rpsgroup.com/ireland
 E ireland@rpsgroup.com

Project **3FMProject** Bringing Dublin Port to 2040

Title **RO-RO-TERMINAL (AREA K) PROPOSED WASTEWATER DRAINAGE LAYOUT**

Model File Identifier

File Identifier **CP1901-3FM-RPS-S45-04-DR-C-0432**

Created on	18/10/2023	Sheets	1 OF 1
Scale	1:1000 @ A1 1:2000 @ A3	Status	S4
		Rev	P03

Q:\IE000373 - Dublin Port 3FM Project\8.0 Drawings\Drainage\DR\CP1901-3FM-RPS-S45-04-DR-C-0432 (Area K).dwg