

**NOTES**

1. Verifying Dimensions.  
Dimensions shall be verified against such other drawings or site conditions as pertain to this part of the work.
2. Existing Services.  
Any information concerning the location of existing services indicated on this drawing is intended for general guidance only.
3. Datum.  
Ordnance Datum Malin (unless noted otherwise)
4. ESB refers to Electricity Service Board  
CD refers to Chart Datum  
OD refers to Ordnance Datum Malin  
M.H.W.S. Mean High Water Springs  
M.L.W.S. Mean Low Water Springs  
Reeler refers to Refrigerated Container
5. Refer to drawing CP1901-3FM-RPS-S45-06-DR-C-0601 to 0606 for section locations.
6. Section and elevation details refer to CP1901-3FM-RPS-S45-06-DR-C-0607 to 0615
7. Proposed Drainage Layout refer to CP1901-3FM-RPS-S45-06-DR-C-0616
8. Refer to Highways Engineering (HE) Series drawings for Proposed Approach Road details

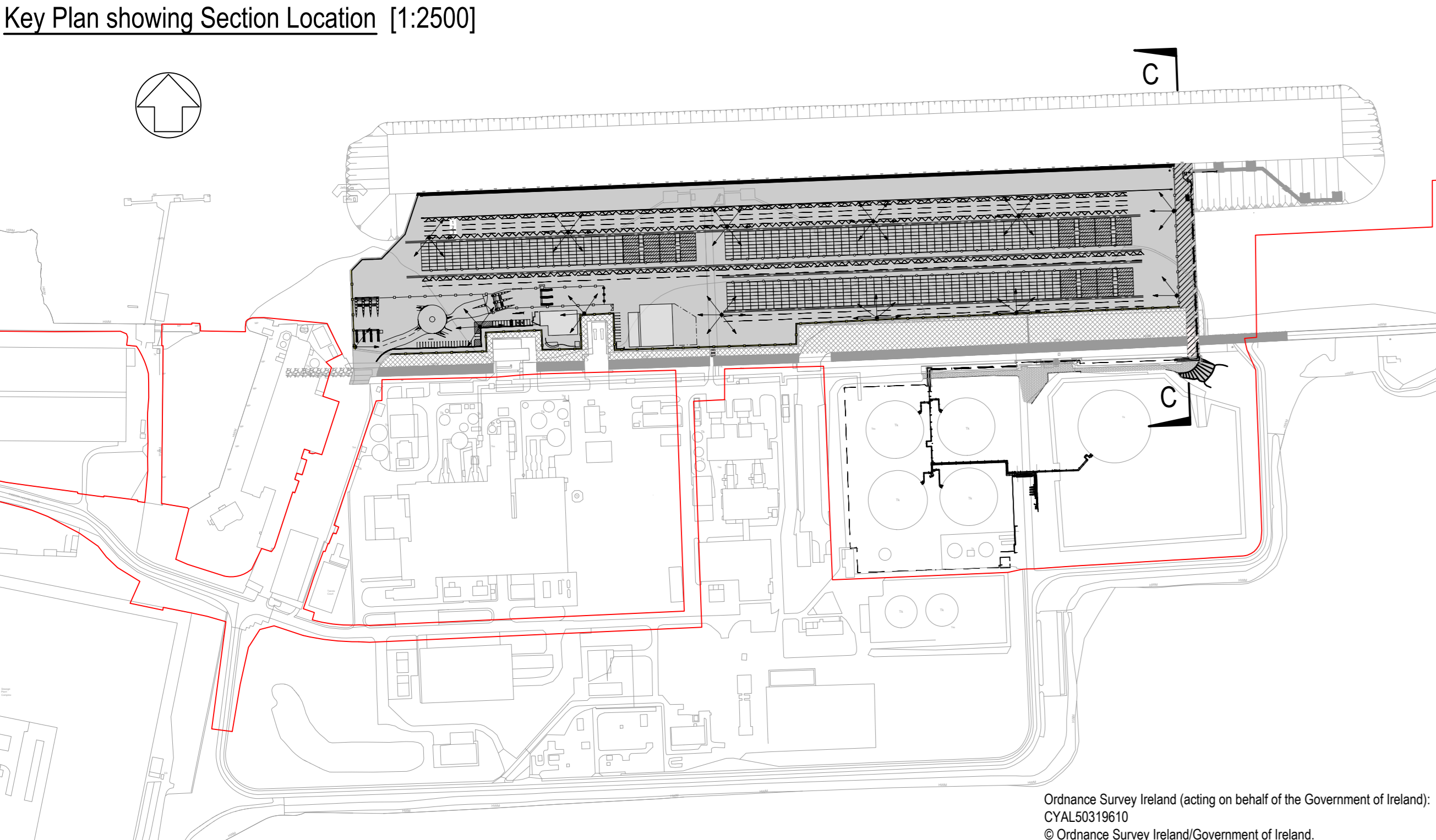
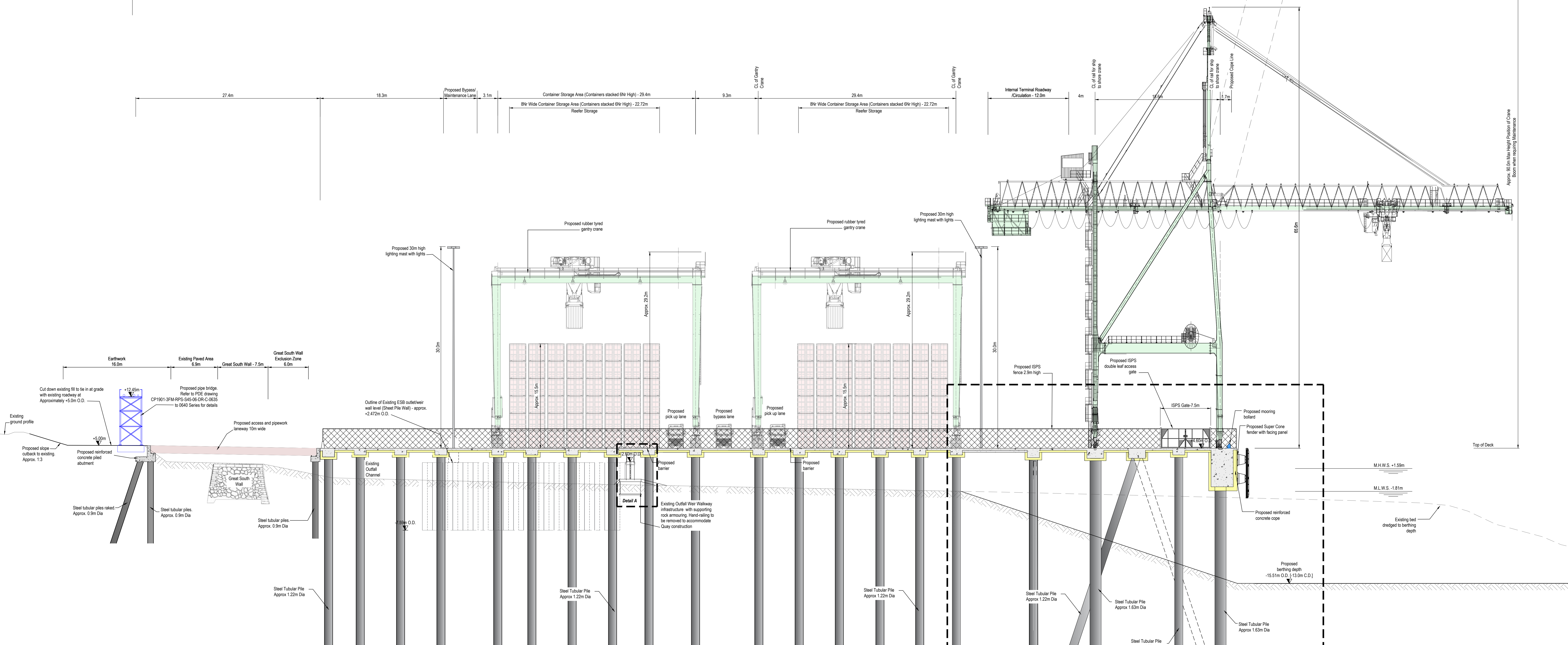
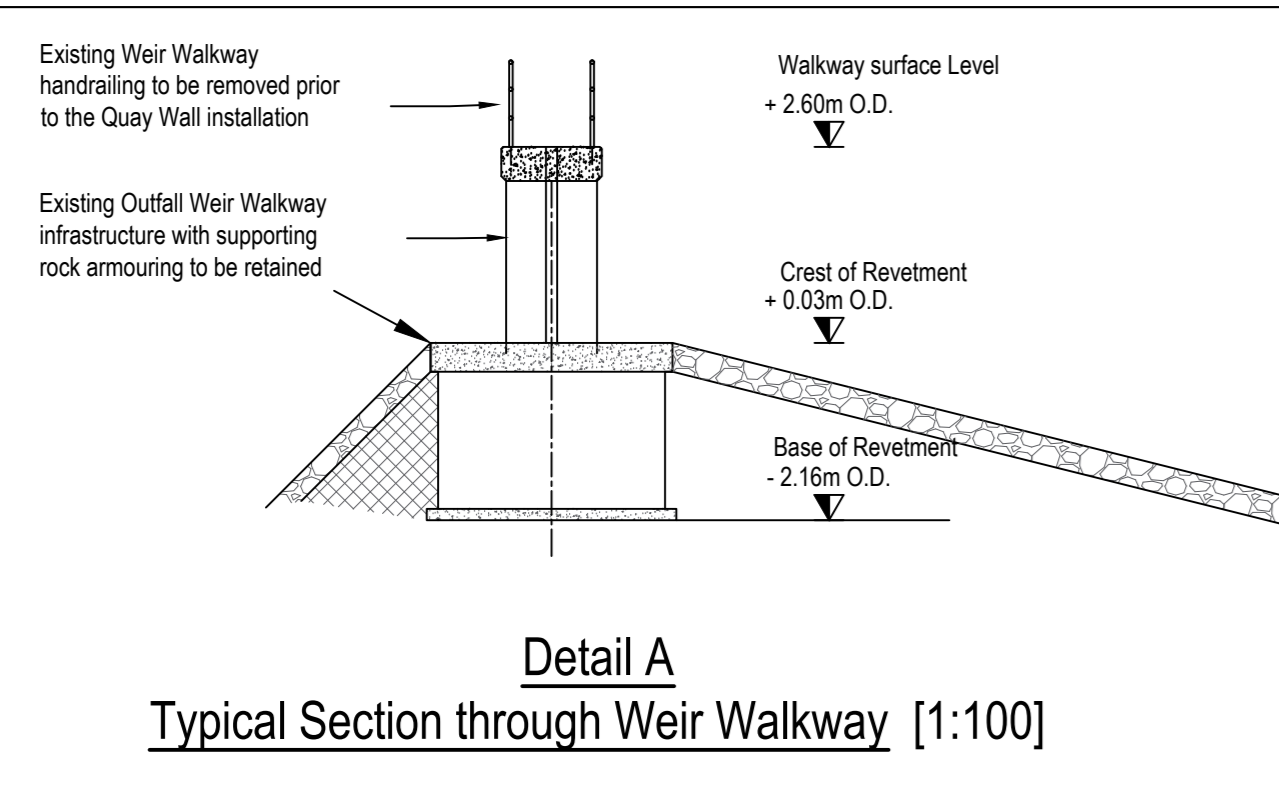

Section C-C [1:200]

P05	Revised for Planning Issue	M.H.	28/06/2024
rev	amendments	check	date
		T +44 (0) 28 30 667014 F +44 (0) 28 30 666286 W www.rpsgroup.com/ireland E ireland@rpsgroup.com	
Client 			
Project 			
Title Lo-Lo Container Terminal (Area N) Proposed Cross Section C-C			
Project Number	Sheet Size	Drawing Scale	
IBM0842	A0	As Shown	
Drawing Number			
CP1901-3FM-RPS-S45-06-DR-C-0609			
Drawn By	Status	Revision	
M.H.	S4	P05	
Checked By	Approved By	Date	
K.A.G.	M.M.C.	20/07/2023	