

Lo-Lo Container Yard (Area L) Section Key Plan [1:2500]

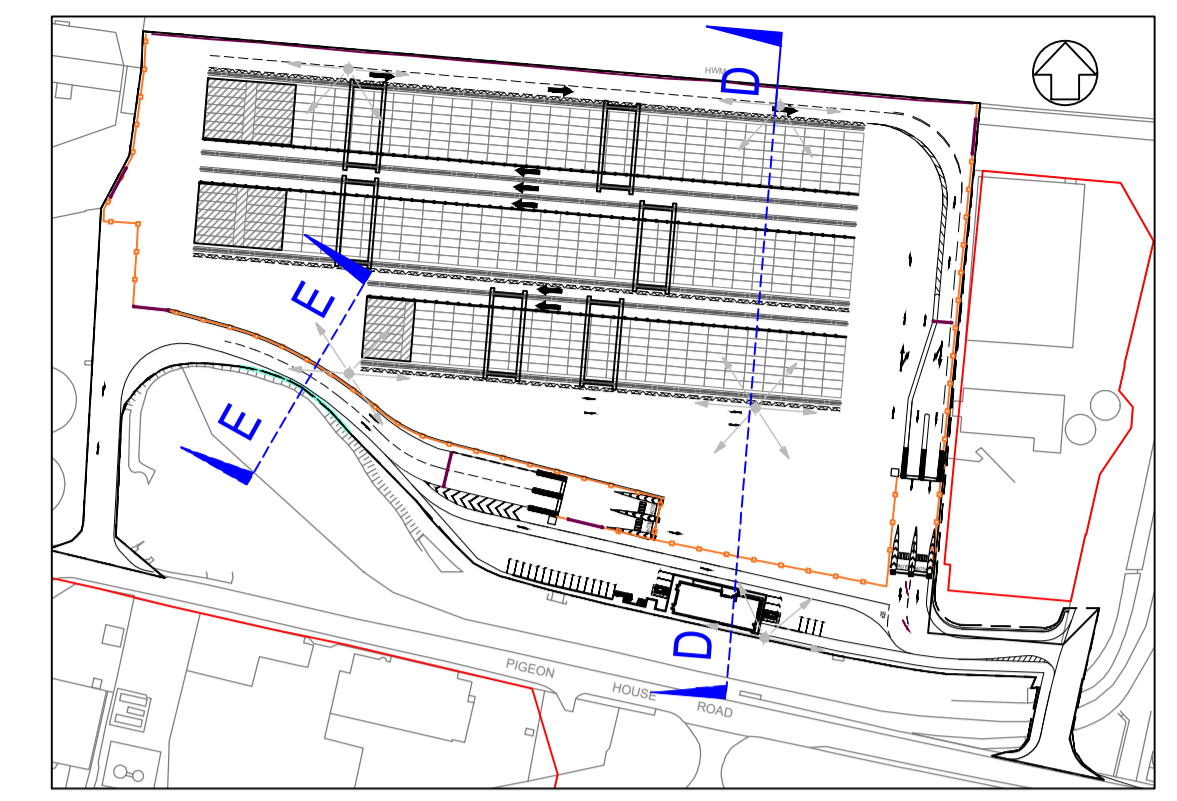

Ordnance Survey Ireland (acting on behalf of the Government of Ireland):
CYAL50319610
© Ordnance Survey Ireland/Government of Ireland.

- NOTES**
1. Verifying Dimensions. Dimensions shall be verified against such other drawings or site conditions as pertain to this part of the work.
 2. Existing Services. Any information concerning the location of existing services indicated on this drawing is intended for general guidance only.
 3. Datum. Ordnance Datum Malin (unless noted otherwise)
 4. CWP refers to Coding Wind Park
OD refers to Ordnance Datum Malin
eRMG refers to Electric Rail Mounted Gantry Crane
 5. Section and elevation locations
CP1901-3FM-RPS-S45-07-DR-C-0801
 6. Refer to drawing CP1901-3FM-RPS-S45-06-DR-C-0809 for Drainage Layout.
 7. Refer to drawing CP1901-3FM-RPS-S45-06-DR-C-0808 for Surface Levels
 8. Refer to drawing CP1901-3FM-RPS-S45-06-DR-C-0807 for Construction Surface Makeup

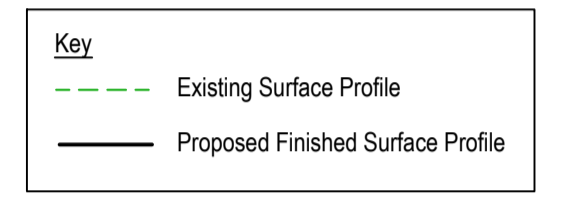
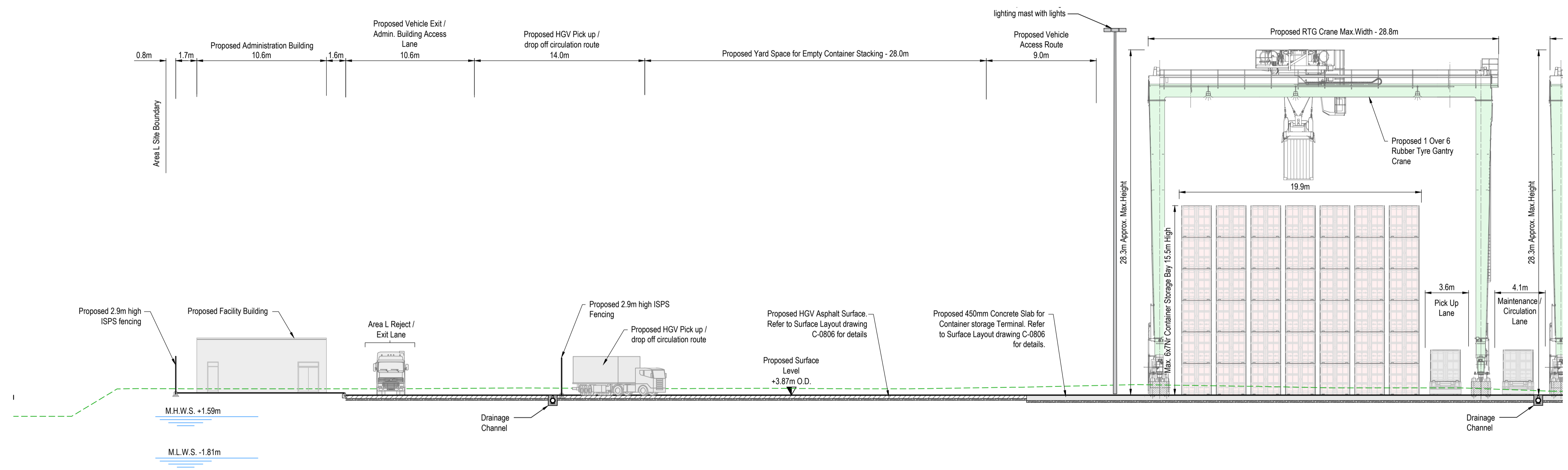
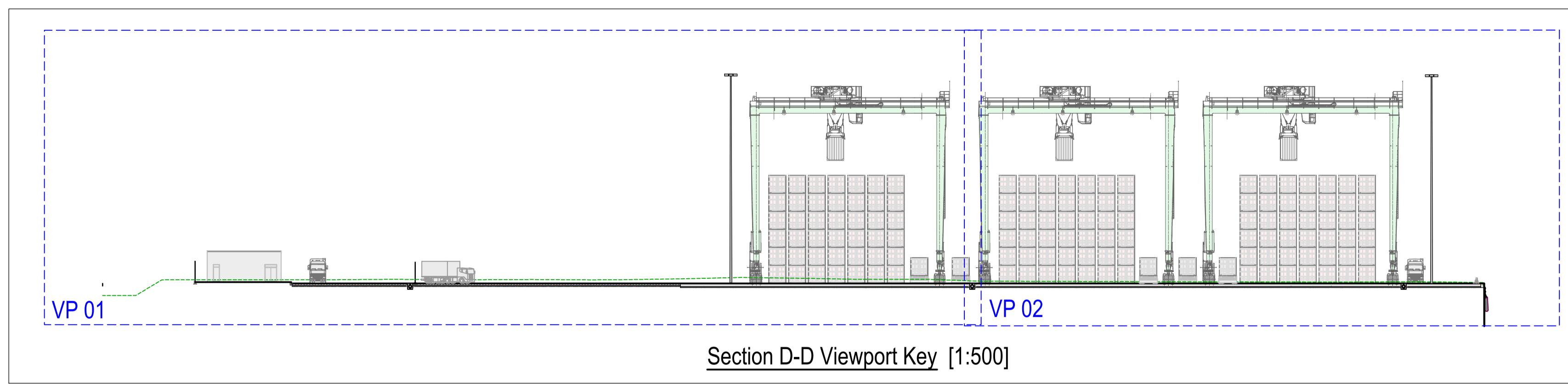

Section D-D: VP 01 [1:200]

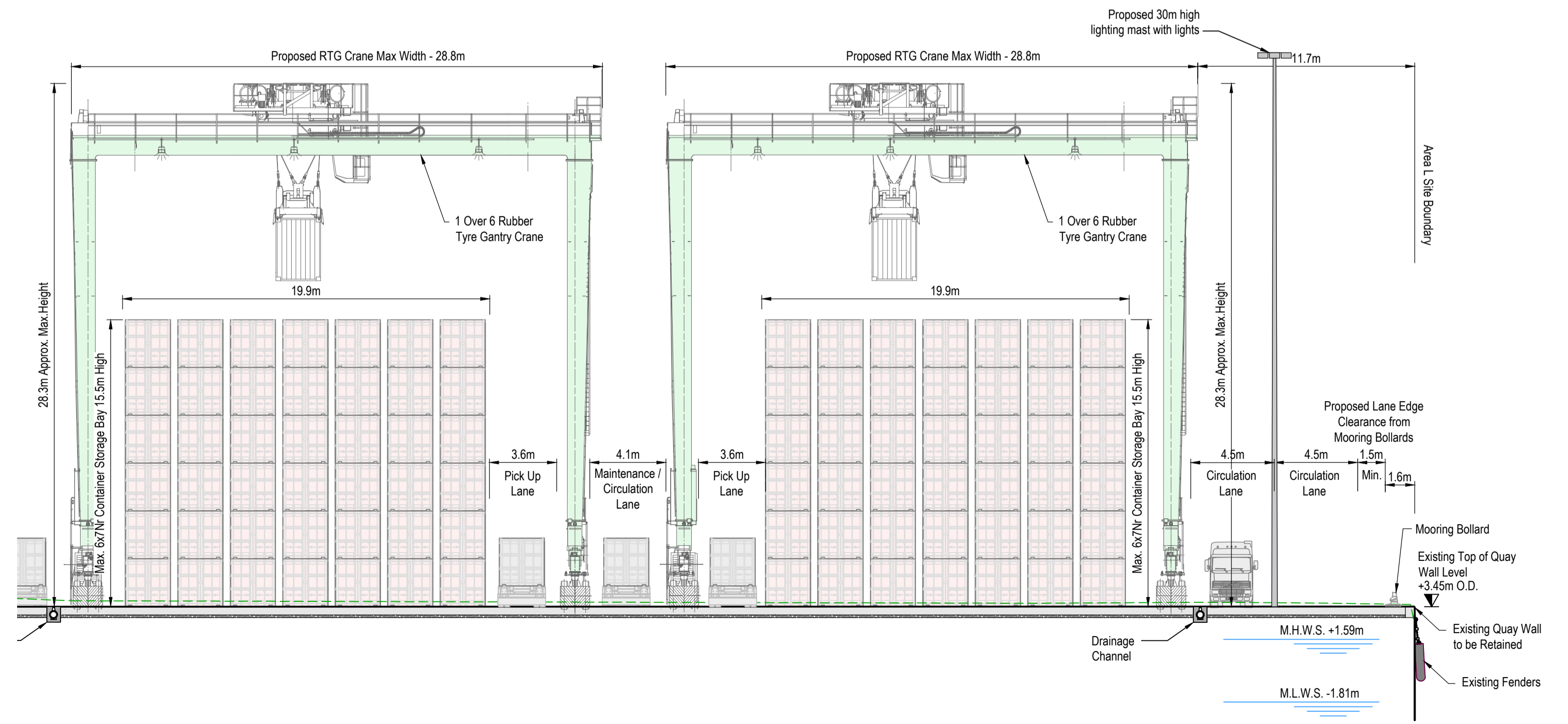

Section D-D: VP 02 [1:200]

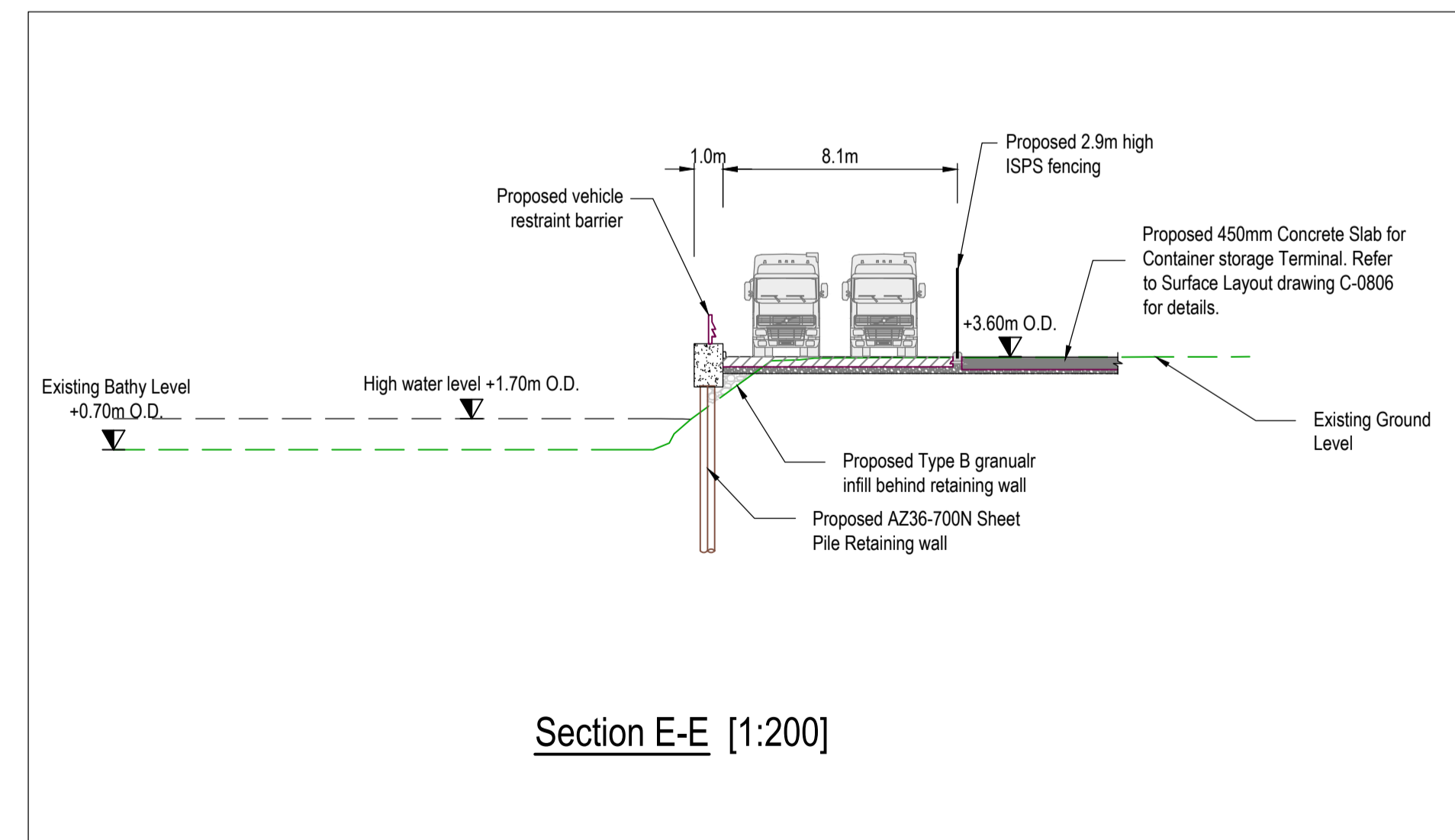

Section E-E [1:200]

P07	Revised for Planning Issue	B.M.	28/06/2024
rev	amendments	check	date

rps Elmwood House
74 Boucher Road
Belfast
BT12 6RZ
T +44 (0) 28 90 667914
F +44 (0) 28 90 668286
W www.rpsgroup.com/ireland
E ireland@rpsgroup.com

Client
**COMHLACHT CHALAFORT
ATHA CLIATH
DUBLIN PORT COMPANY**

Project
3FMProject Ag tabhairt Chalafort Atha Cliath go 2040

Title
Lo-Lo Container Yard (Area L)
Proposed Section D-D & E-E

Project Number IBM0842	Sheet Size A1	Drawing Scale 1:200
---------------------------	------------------	------------------------

Drawing Number
CP1901-3FM-RPS-S45-08-DR-C-0805

Drawn By J.R.	Status S4	Revision P07
------------------	--------------	-----------------

Checked By B.M.	Approved By M.McC.	Date 01/03/2024
--------------------	-----------------------	--------------------