

River Liffey

Table showing Catchment Areas and Interceptor Sizes				
Catchment Area	Key	Area Size	Interceptor Spec	Interceptor Length
Area 1	Yellow	11,850m ²	NSFA285	15.83m
Area 2	Pink	15,050m ²	NSFA285	15.83m
Area 3	Green	3,700m ²	NSFA080	5.74m
Area 4	Light Blue	14,000m ²	NSFA285	15.83m

*Note: Surface water to be conveyed to interceptors using ACO 'Q-Max' type aqua channels. Maintenance chambers to be included for maintenance/sitting purposes, placed at approx. 80m c/c's

NOTES

- Verifying Dimensions. Dimensions shall be verified against such other drawings or site conditions as pertain to this part of the work.
- Existing Services. Any information concerning the location of existing services indicated on this drawing is intended for general guidance only.
- Datum. Ordnance Datum Malin (unless noted otherwise)
- CWP refers to Codling Wind Park
OD refers to Ordnance Datum Malin
eRMG refers to Electric Rail Mounted Gantry Crane
- Section and elevation locations
CP1901-3FM-RPS-S45-07-DR-C-0801
- Refer to drawing CP1901-3FM-RPS-S45-06-DR-C-0808 for Surface Levels.
- Refer to drawing CP1901-3FM-RPS-S45-06-DR-C-0807 for Construction Surface Makeup.
- Refer to drawing CP1901-3FM-RPS-S45-06-DR-C-0807 for Surface Make up Details

Key	
	Drainage Channel with Direction of Flow and Gully
	Drainage Pipe with Direction of Flow
	Proposed NSFA285 Interceptor
	Proposed NSFA080 Interceptor
	Manhole
	Planning Boundary under this application

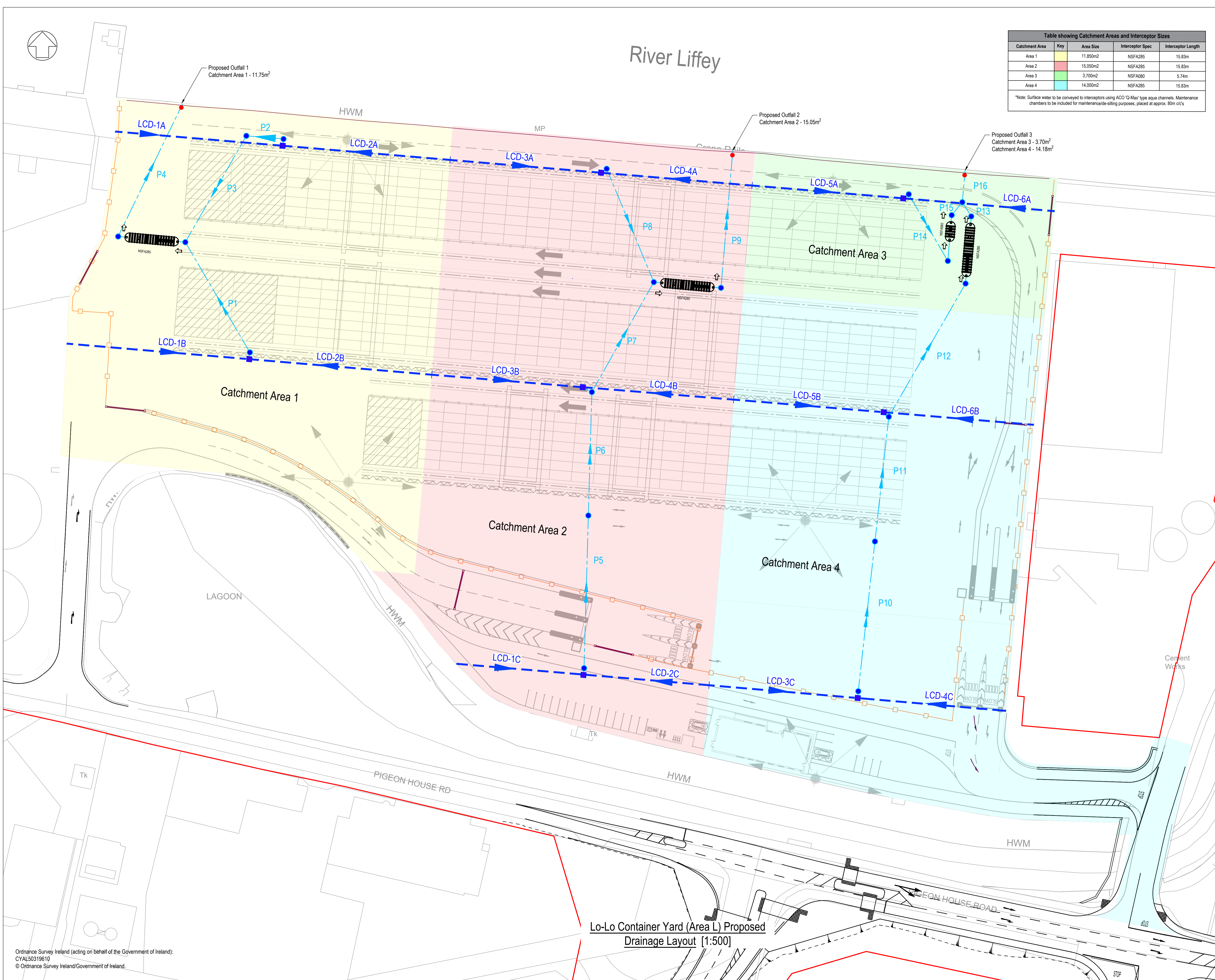

P07	Revised for Planning Issue	M.H.	28/06/2024
rev	amendments	check	date

rps Elmwood House
74 Boucher Road
Belfast
BT12 6RZ

T +44 (0) 28 90 667914
F +44 (0) 28 90 668286
W www.rpsgroup.com/ireland
E ireland@rpsgroup.com

Client

**COMHLACHT CHALAFORT
ATHA CLIATH
DUBLIN PORT COMPANY**

Project

3FMProject Ag tabhairt
CBalafort Atha
Cliath go 2040

Title
**Lo-Lo Container Yard (Area L)
Proposed Drainage Layout**

Project Number IBM0842	Sheet Size A1	Drawing Scale 1:500 UNO
---------------------------	------------------	----------------------------

Drawing Number
CP1901-3FM-RPS-S45-08-DR-C-0809

Drawn By J.R.	Status S4	Revision P07
------------------	--------------	-----------------

Checked By B.M.	Approved By M.McC.	Date 26/02/2024
--------------------	-----------------------	--------------------

**Lo-Lo Container Yard (Area L) Proposed
Drainage Layout [1:500]**