

- NOTES**
1. Verifying Dimensions. Dimensions shall be verified against such other drawings or site conditions as pertain to this part of the work.
 2. Existing Services. Any information concerning the location of existing services indicated on this drawing is intended for general guidance only.
 3. Datum. Ordnance Datum Mean (unless noted otherwise)
 4. For Proposed Marina Layout, refer to drawing CP1901-3FM-RPS-S45-03-DR-C-0001
 5. All works to be removed on completion of 3FM Construction
 6. For Overall 3FM Maritime Proposed Temporary Works refer to CP1901-3FM-RPS-S45-09-DR-C-0000
- Planning Boundary under this application

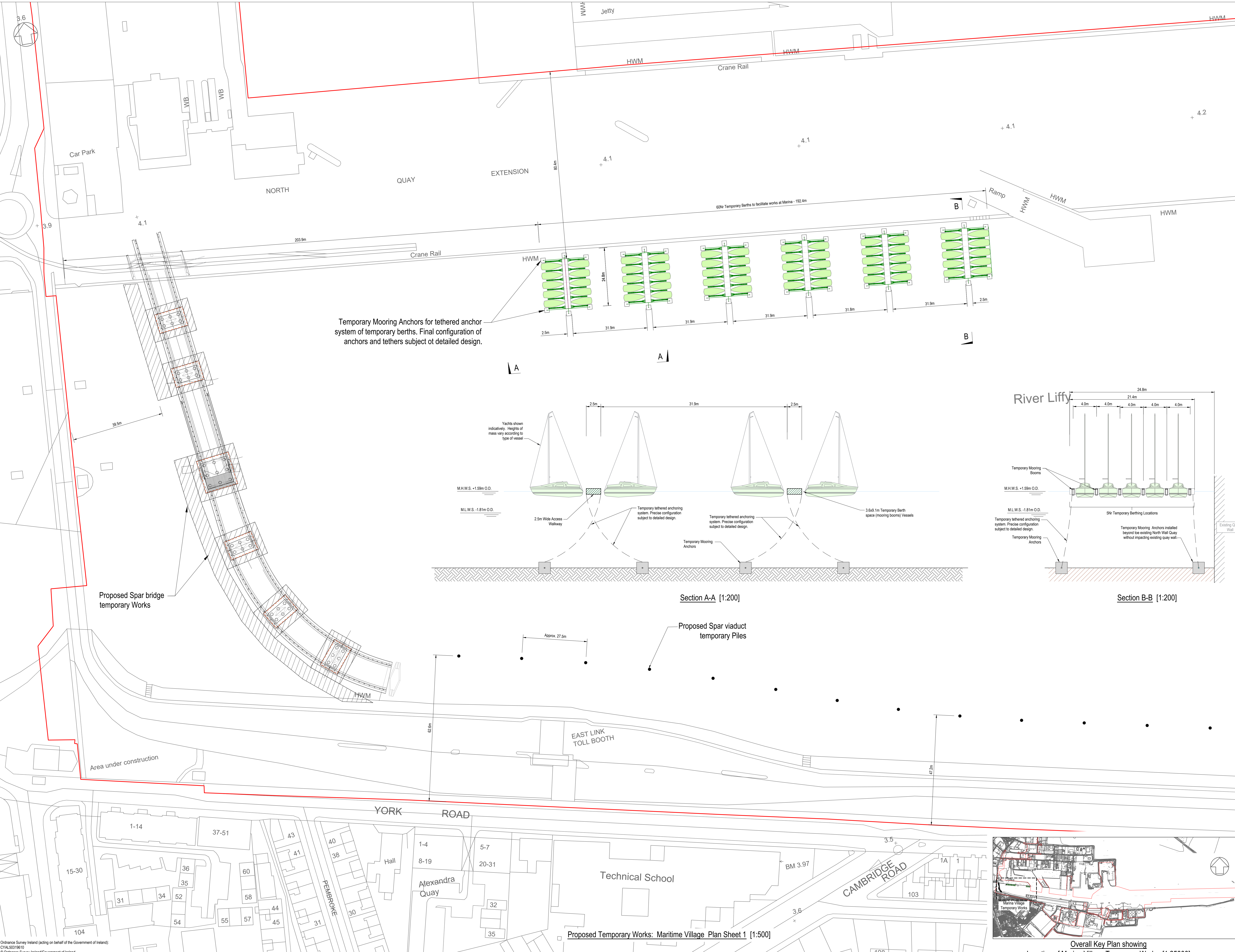

Temporary Mooring Anchors for tethered anchor system of temporary berths. Final configuration of anchors and tethers subject of detailed design.

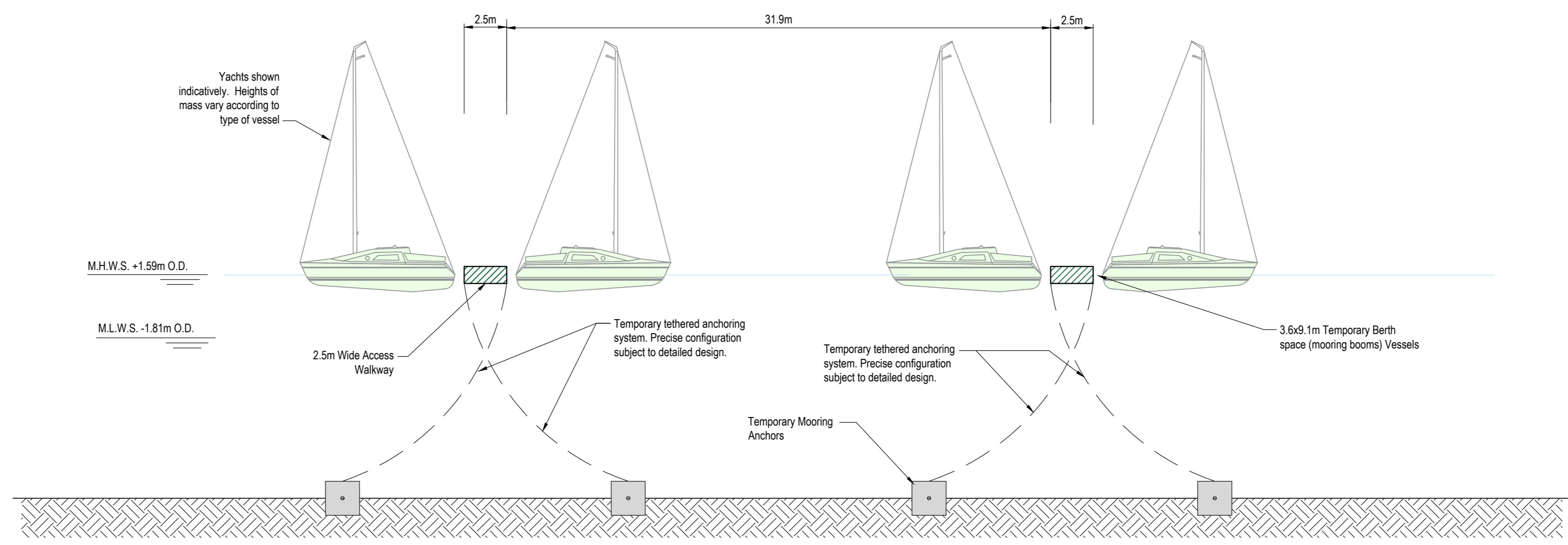

Section A-A [1:200]

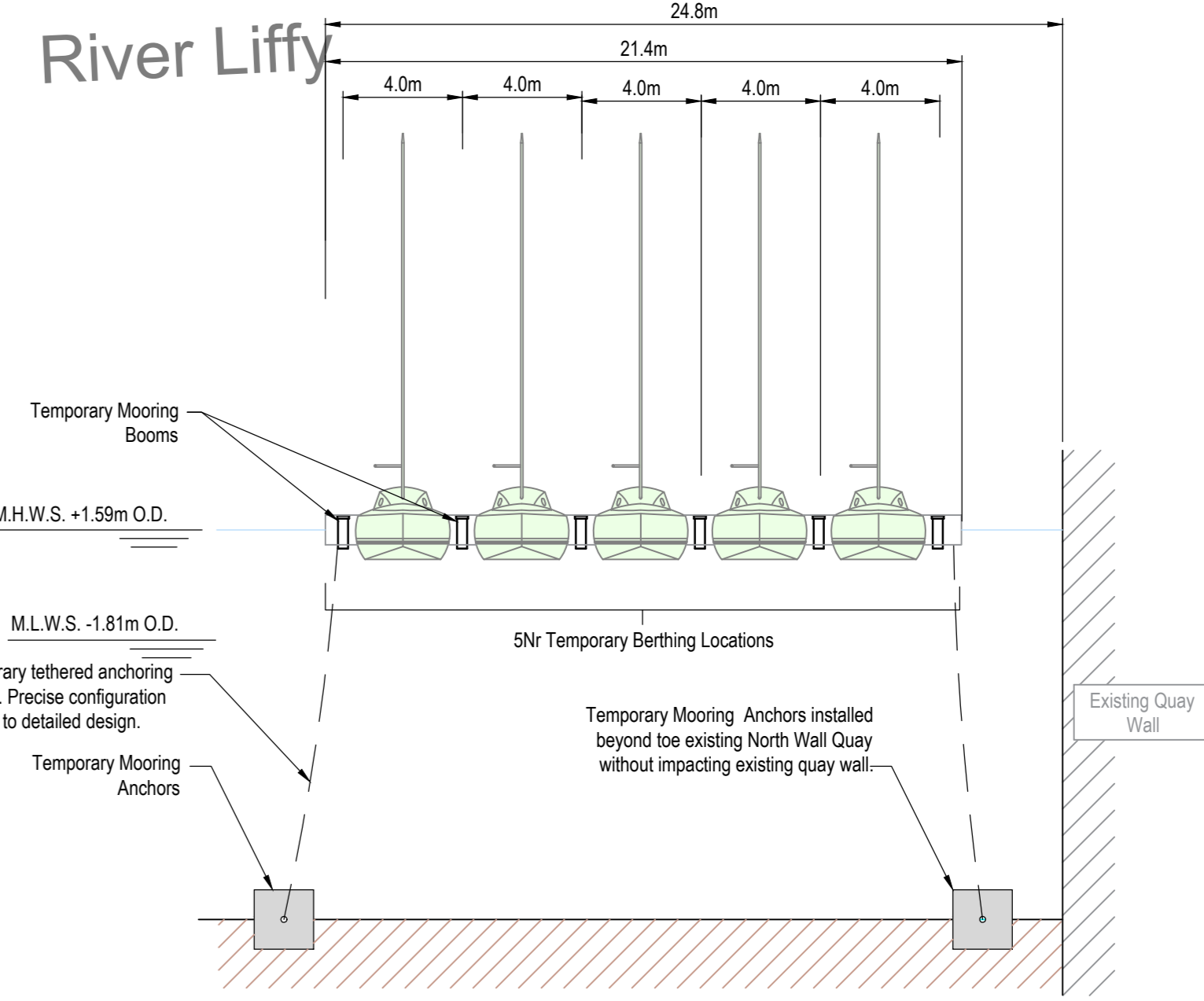

Section B-B [1:200]

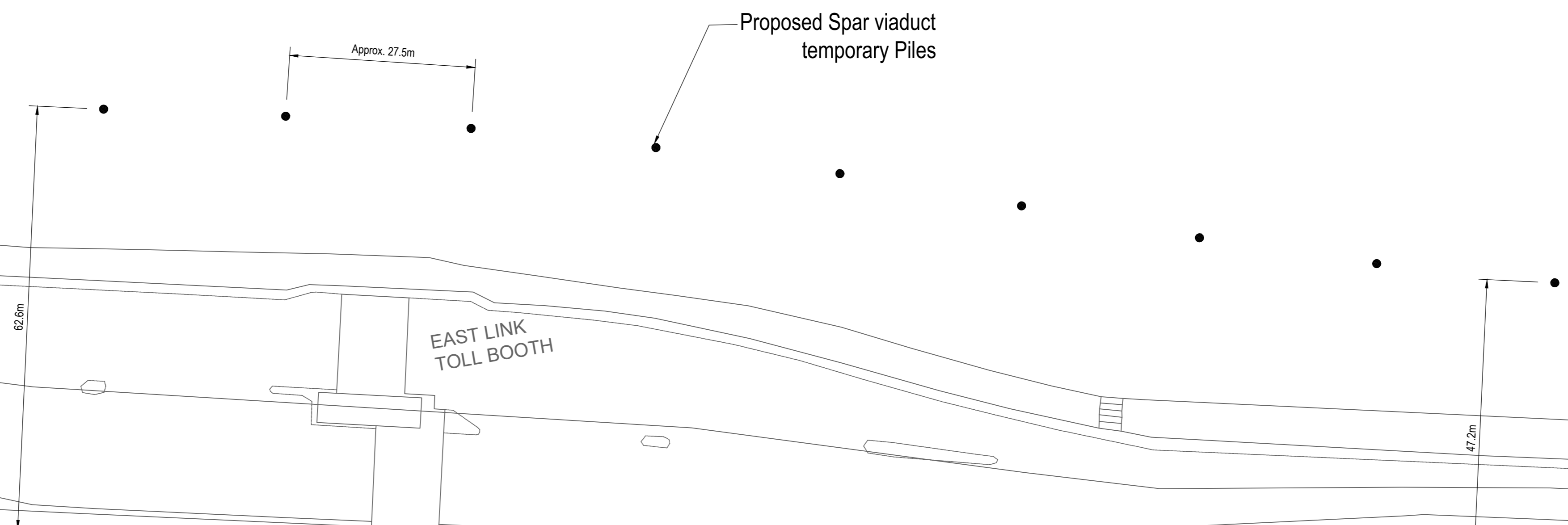

Proposed Spar viaduct temporary Piles

Proposed Temporary Works: Maritime Village Plan Sheet 1 [1:500]



Overall Key Plan showing Location of Marina Village Temporary Works [1:25000]

Ordnance Survey Ireland (acting on behalf of the Government of Ireland)
CYAL50319610
© Ordnance Survey Ireland/Government of Ireland.

PO2	Revised for Planning Issue	B.M.	28/09/2024
PO1	Issued for Review and Comment	E.M.	17/05/2024
rev	amendments	check	date

Client: **COMHLACHT CHALAFORT**
ALTA CLIAIRTE
DUBLIN PORT COMPANY

Project: **3FMProject**
An tSábhairt Chláraithe agus Clárúcháir

Title: **Proposed Temporary Works**
Maritime Village Sheet 1

Project Number	Sheet Size	Drawing Scale
IBM0842	A0	As Shown

Drawing Number: **CP1901-3FM-RPS-S45-09-DR-C-0001**

Drawn By	Status	Revision
J.R.	S4	P02

Checked By	Approved By	Date
M.McC.	M.McC.	17/05/2024