

Typical Section on Bond Drive  
Section C - C  
1:50

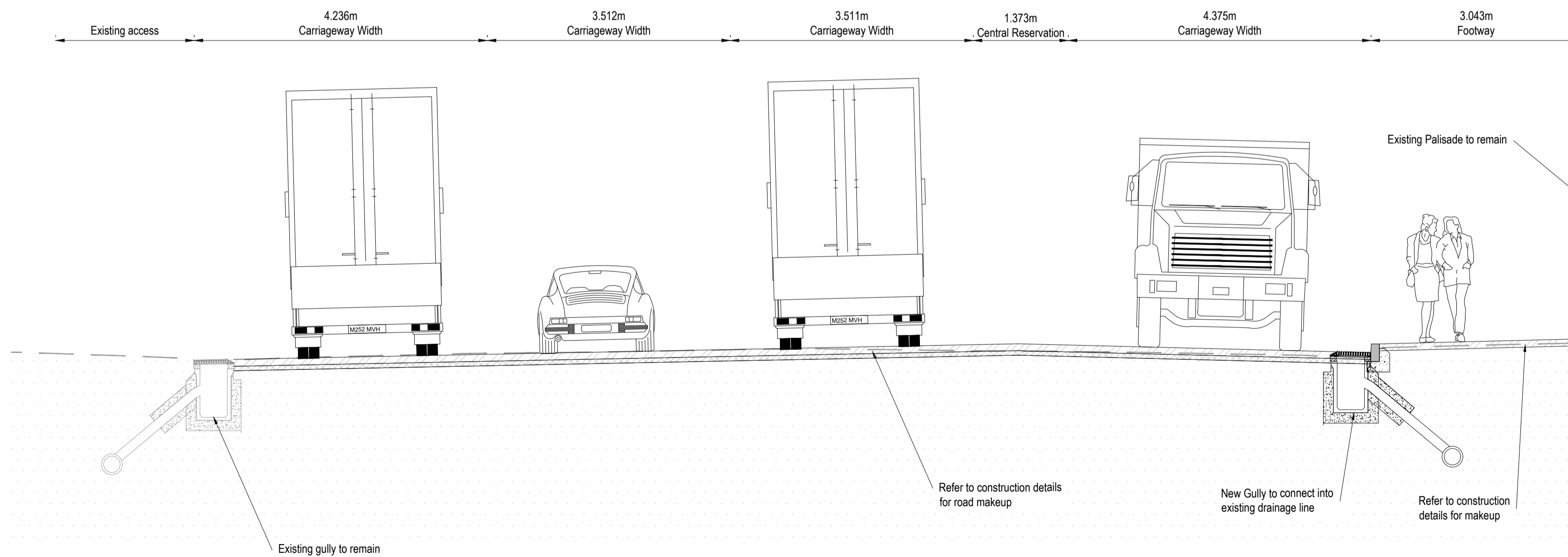
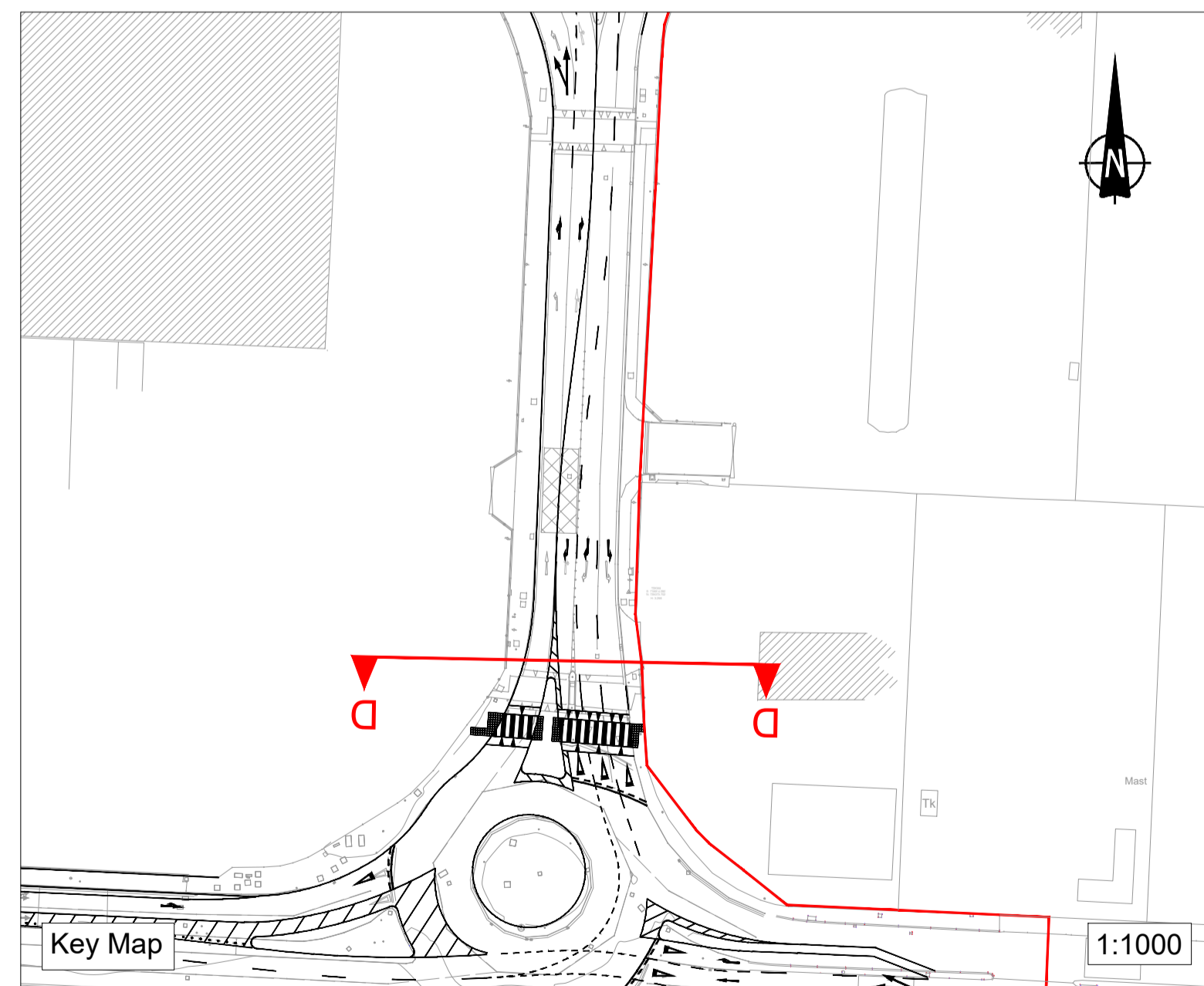

Typical Section on Bond Drive  
Section D - D  
1:50

**NOTES**

1. Verifying Dimensions.  
The contractor shall verify dimensions against such other drawings or site conditions as pertain to this part of the work.
2. Existing Services.  
Any information concerning the location of existing services indicated on this drawing is intended for general guidance only. It shall be the responsibility of the contractor to determine and verify the exact horizontal and vertical alignment of all cables, pipes, etc. (both underground and overhead) before work commences.
3. Issue of Drawings.  
Hard copies, dwf and pdf will form a controlled issue of the drawing. All other formats (dwg, dxf etc.) are deemed to be an uncontrolled issue and any work carried out based on these files is at the recipient's own risk. RPS will not accept any responsibility for any errors arising from the use of these files, either by human error by the recipient, listing of un-dimensioned measurements, compatibility issues with the recipient's software, and any errors arising when these files are used to aid the recipient's drawing production, or setting out on site.
4. OS Map Sheet No  
3198-13, 3198-14, 3198-15, 3198-18, 3198-19, 3198-20, 3198-23, 3198-24, 3198-25, 3264-03, 3264-04, 3264-05, 3264-08, 3264-09, 3264-10, 3264-13, 3264-14, 3264-15, 3264-18, 3264-19, 3264-20, 3199-11, 3199-12, 3199-13, 3199-14, 3199-15, 3199-16, 3199-17, 3199-18, 3199-19, 3199-21, 3199-22, 3199-23, 3199-24, 3265-01, 3265-02, 3265-03, 3265-04, 3265-06, 3265-07, 3265-08, 3265-09, 3265-10, 3265-11, 3265-12, 3265-16
5. Datum. ITM

Plan Key	
Existing Layout	—————
Proposed Layout	—————
Proposed Earthworks	- - - - -
Application Boundary	—————
Section Key	
Proposed Layout	—————
Existing Ground Level	—————

rev	amendments	check	date

**rps** Elmwood House  
74 Boucher Road  
Belfast  
BT12 6RZ  
T +44 (0) 28 90 667914  
F +44 (0) 28 90 668286  
W www.rpsgroup.com/ireland  
E ireland@rpsgroup.com

Client  
**COMHLACHT CHALAFORT  
ATHA CLIATH  
DUBLIN PORT COMPANY**

Project  
**3FMProject** Bringing  
Dublin Port  
To 2040

Title  
**Roads & Footways (Northern) -  
Typical Sections - Bond Drive South**

Project Number	Sheet Size	Drawing Scale
IBH0796	A1	As Shown

Drawing Number  
**CP1901\_3FM-RPS\_S26-GEN-NP-DR-HE-100-0002**

Drawn By	Status	Revision
AM	S4	-

Checked By	Approved By	Date
JF	CD	May 2024