

Typical Section on Whitebank road
1:50

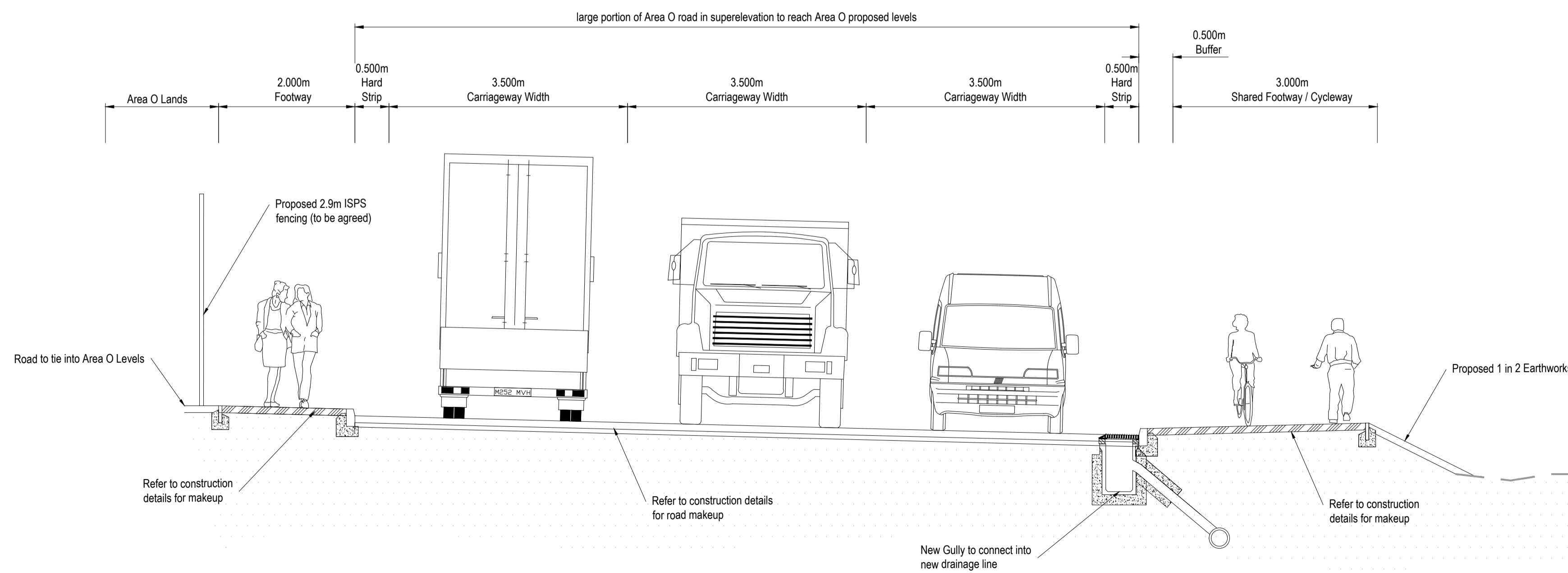
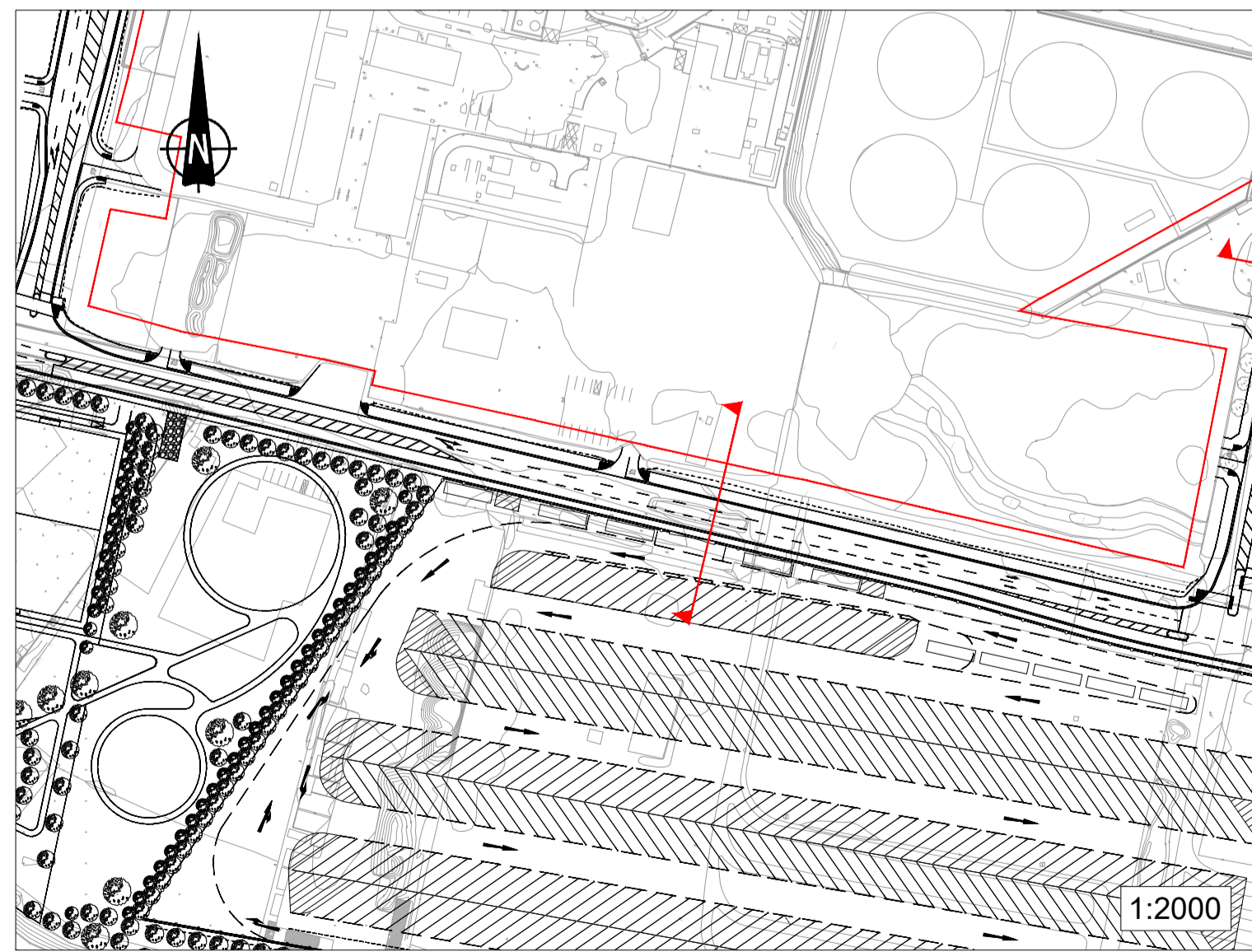

Typical Section on Area O Access road
1:50

NOTES

- Verifying Dimensions.
The contractor shall verify dimensions against such other drawings or site conditions as pertain to this part of the work.
- Existing Services.
Any information concerning the location of existing services indicated on this drawing is intended for general guidance only. It shall be the responsibility of the contractor to determine and verify the exact horizontal and vertical alignment of all cables, pipes, etc. (both underground and overhead) before work commences.
- Issue of Drawings.
Hard copies, dwf and pdf will form a controlled issue of the drawing. All other formats (dwg, dxf etc.) are deemed to be an uncontrolled issue and any work carried out based on these files is at the recipient's own risk. RPS will not accept any responsibility for any errors arising from the use of these files, either by human error by the recipient, listing of un-dimensioned measurements, compatibility issues with the recipient's software, and any errors arising when these files are used to aid the recipient's drawing production, or setting out on site.
- OS Map Sheet No
3198-13, 3198-14, 3198-15, 3198-18, 3198-19, 3198-20, 3198-23, 3198-24, 3198-25, 3264-03, 3264-04, 3264-05, 3264-08, 3264-09, 3264-10, 3264-13, 3264-14, 3264-15, 3264-18, 3264-19, 3264-20, 3199-11, 3199-12, 3199-13, 3199-14, 3199-15, 3199-16, 3199-17, 3199-18, 3199-19, 3199-21, 3199-22, 3199-23, 3199-24, 3265-01, 3265-02, 3265-03, 3265-04, 3265-06, 3265-07, 3265-08, 3265-09, 3265-10, 3265-11, 3265-12, 3265-16
- Datum: ITM

Plan Key	
	Proposed layout
	Proposed earthworks
	Existing Survey
	Application Boundary

Great South Wall (GSW) Key	
	GSW - Existing above ground structure
	GSW later additions remaining (Pigeon House Fort & Harbour)
	GSW later additions assumed below ground (Pigeon House Fort & Harbour)
	GSW assumed below ground
	Proposed restoration of GSW parapet
	Proposed removal of GSW parapet
	Proposed reconstruction of GSW parapet

P02	Revised for Planning submission	CD	27/08/24
P01	Revised for planning	PN	02/10/23
rev	amendments	check	date

RPS Elmwood House
74 Boucher Road
Belfast BT12 6RZ
T +44 (0) 28 90 667914
F +44 (0) 28 90 668286
W www.rpsgroup.com/ireland
E ireland@rpsgroup.com

Client
**COMHLACHT CHALAFORT
ATHA CIATH
DUBLIN PORT COMPANY**

Project
3FMProject Bringing Dublin Port To 2040

Title
**Roads & Footways (Southern & SPAR) -
Typical Sections
Sheet 2**

Project Number IBH0796	Sheet Size A1	Drawing Scale As Shown
---------------------------	------------------	---------------------------

Drawing Number
CP1901_3FM-RPS_S26-GEN-XX-DR-HE-100-0002

Drawn By DMI	Status S4	Revision P02
-----------------	--------------	-----------------

Checked By PN	Approved By CDo	Date Dec 2022
------------------	--------------------	------------------