

VIEWPORT 4a

VIEWPORT 4b

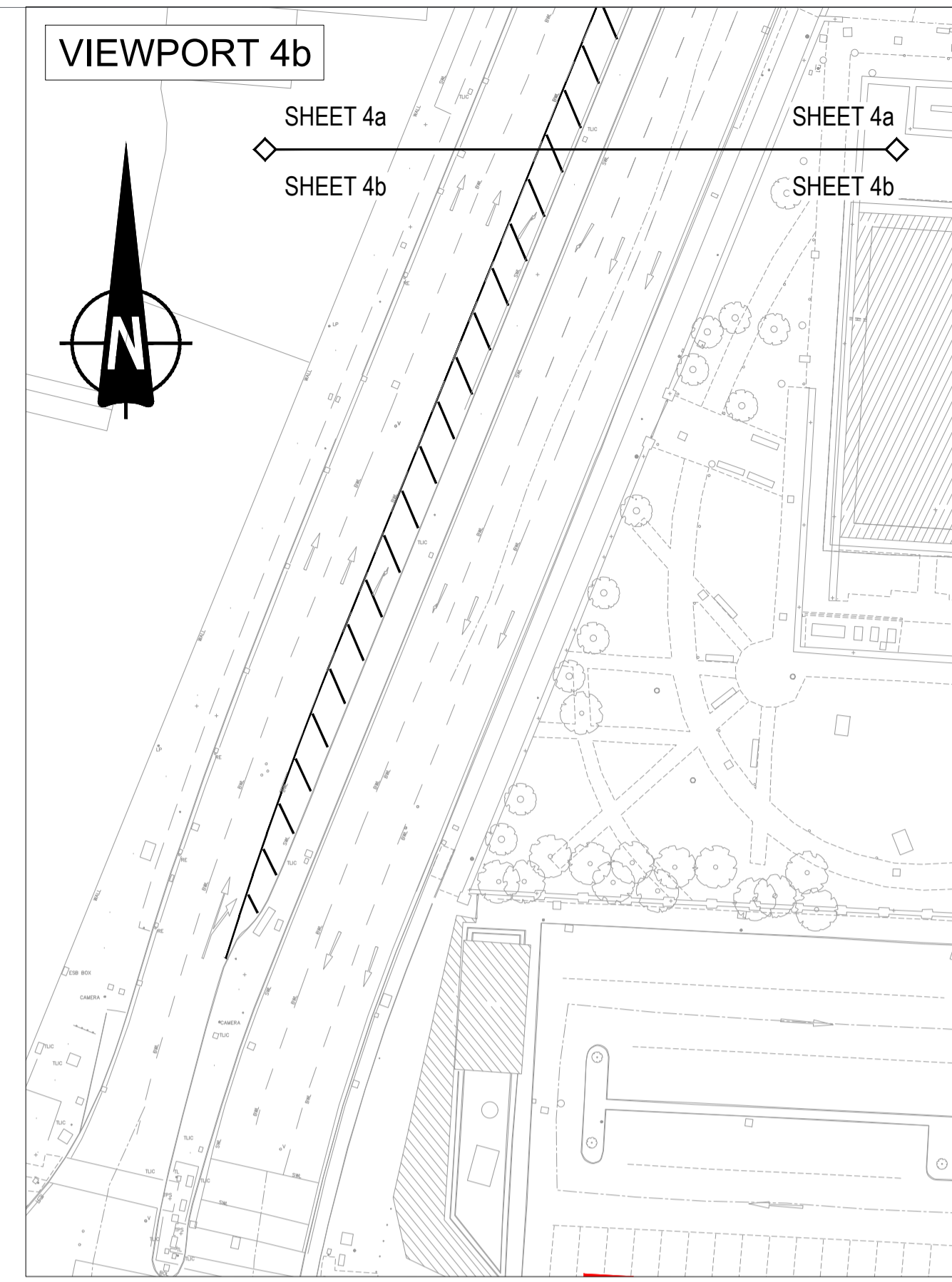
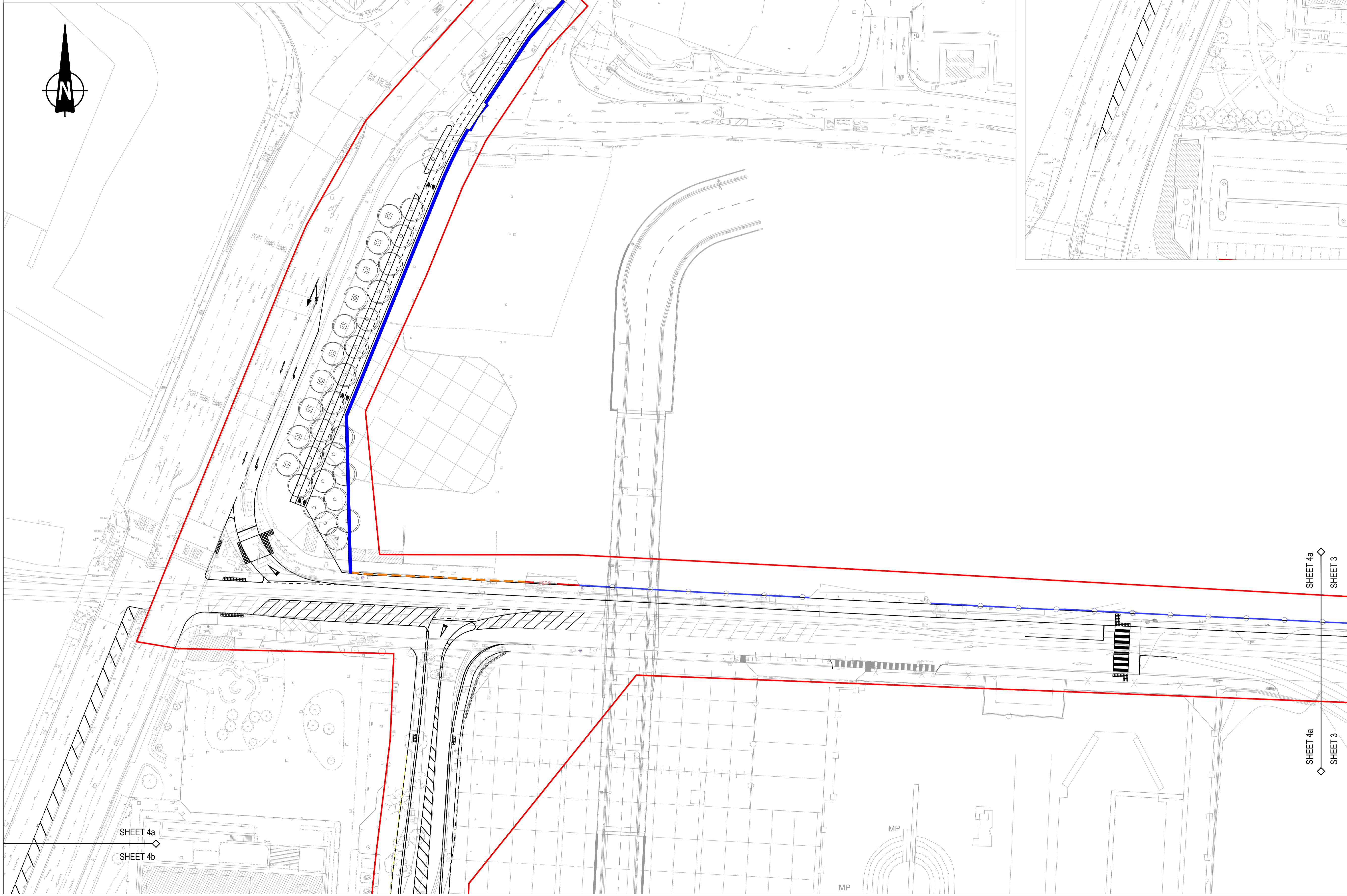

- NOTES**
1. Verifying Dimensions.
The contractor shall verify dimensions against such other drawings or site conditions as pertain to this part of the work.
 2. Existing Services.
Any information concerning the location of existing services indicated on this drawing is intended for general guidance only. It shall be the responsibility of the contractor to determine and verify the exact horizontal and vertical alignment of all cables, pipes, etc. (both underground and overhead) before work commences.
 3. Issue of Drawings.
Hard copies, dwf and pdf will form a controlled issue of the drawing. All other formats (dwg, etc.) are deemed to be an uncontrolled issue and any work carried out based on these files is at the recipient's own risk. RPS will not accept any responsibility for any errors arising from the use of these files, either by human error or by the recipient, listing of un-dimensioned measurements, compatibility issues with the recipient's software, and any errors arising when these files are used to aid the recipient's drawing production, or setting out on site.
 4. OS Map Sheet No
3198-13, 3198-14, 3198-15, 3198-18, 3198-19, 3198-20, 3198-23, 3198-24, 3198-25, 3264-03, 3264-04, 3264-05, 3264-08, 3264-09, 3264-10, 3264-13, 3264-14, 3264-15, 3264-18, 3264-19, 3264-20, 3199-11, 3199-12, 3199-22, 3199-23, 3199-24, 3265-01, 3265-02, 3265-03, 3265-04, 3265-06, 3265-07, 3265-08, 3265-09, 3265-10, 3265-11, 3265-12, 3265-16
 5. Datum: ITM

- Existing Survey / OS Mapping
Proposed Layout
Proposed Earthworks
Planning Boundary
- Fencing and gates**
- ISPS Proposed Fence (ISPS)
 - Proposed High Security wall
 - Proposed Fence (Paladin / Palisade)
 - Proposed Gate
 - Existing Fence is to be retained
 - Existing Wall and Fence is to be retained
 - Existing Wall to be retained
 - Existing Gate is to be retained
 - Proposed 9m gate

rev	amendments	check	date

rps Elmwood House
74 Boucher Road
Belfast
BT12 6RZ
T +44 (0) 28 90 667914
F +44 (0) 28 90 668286
W www.rpsgroup.com/ireland
E ireland@rpsgroup.com

Client
**COMHLACHT CHALAFORT
ATHA CLIATH
DUBLIN PORT COMPANY**

Project
3FMProject Bringing Dublin Port To 2040

Title
**Roads & Footways (Northern) -
Site fencing and security
Sheet 4**

Project Number IBH0796	Sheet Size A1	Drawing Scale 1:500
---------------------------	------------------	------------------------

Drawing Number
CP1901_3FM-RPS_S26-HFE-NP-DR-HE-300-0004

Drawn By AM	Status S4	Revision -
----------------	--------------	---------------

Checked By CDo	Approved By CDo	Date May 2024
-------------------	--------------------	------------------