

- NOTES**
1. Verifying Dimensions. The contractor shall verify dimensions against such other drawings or site conditions as pertain to this part of the work.
  2. Existing Services. Any information concerning the location of existing services indicated on this drawing is intended for general guidance only. It shall be the responsibility of the contractor to determine and verify the exact horizontal and vertical alignment of all cables, pipes, etc. (both underground and overhead) before work commences.
  3. Issue of Drawings. Hard copies, dwf and pdf will form a controlled issue of the drawing. All other formats (dwg, dxf etc.) are deemed to be an uncontrolled issue and any work carried out based on these files is at the recipient's own risk. RPS will not accept any responsibility for any errors arising from the use of these files, either by human error or by the recipient, listing of un-dimensioned measurements, compatibility issues with the recipient's software, and any errors arising when these files are used to aid the recipient's drawing production, or setting out on site.
  4. OS Map Sheet No. 3198-13, 3198-14, 3198-15, 3198-16, 3198-17, 3198-18, 3198-19, 3198-20, 3198-21, 3198-22, 3198-23, 3198-24, 3198-25, 3264-03, 3264-04, 3264-05, 3264-06, 3264-07, 3264-08, 3264-09, 3264-10, 3264-11, 3264-12, 3264-13, 3264-14, 3264-15, 3264-16, 3264-17, 3264-18, 3264-19, 3264-20, 3199-11, 3199-12, 3199-13, 3199-14, 3199-15, 3199-16, 3199-17, 3199-18, 3199-19, 3199-20, 3199-21, 3199-22, 3199-23, 3199-24, 3265-01, 3265-02, 3265-03, 3265-04, 3265-05, 3265-06, 3265-07, 3265-08, 3265-09, 3265-10, 3265-11, 3265-12, 3265-16
  5. Datum: ITM

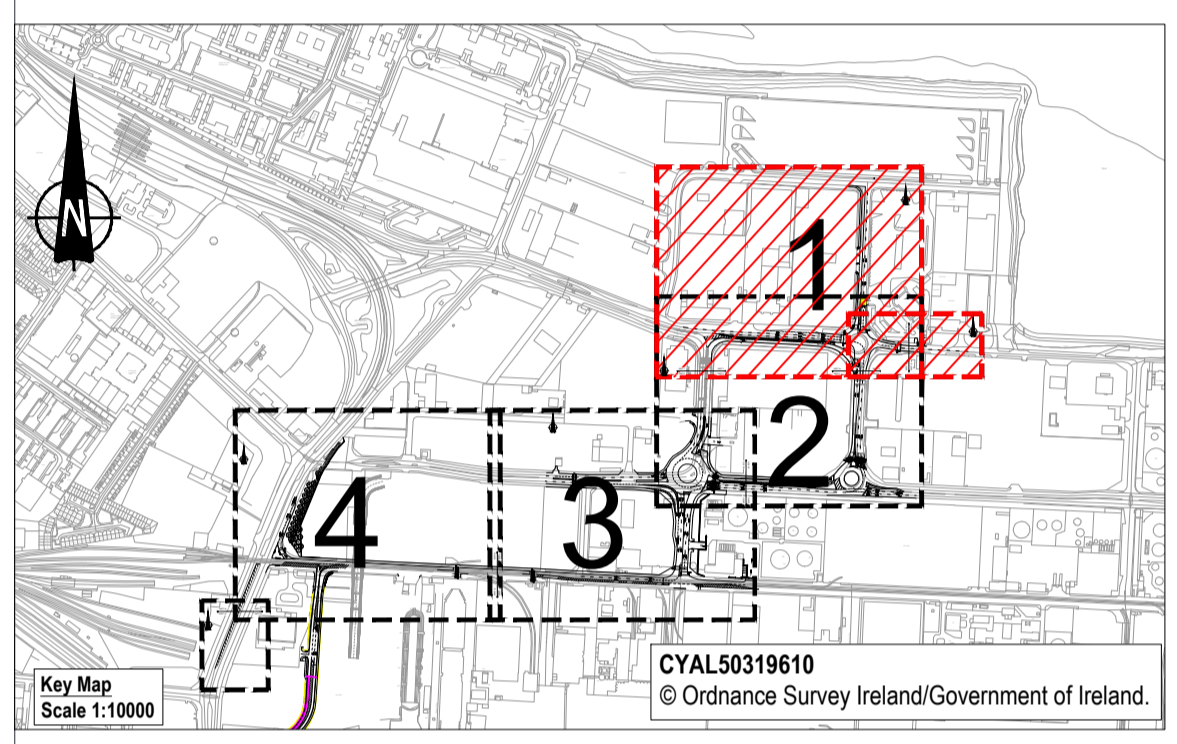

- KEY TO ROAD MARKINGS**
- Road markings details to comply with the "Traffic signs manual Chapter 7 (Republic of Ireland)" and subsequent amending regulations. Diagram numbers are referenced to this document.
- Road markings shall be in thermoplastic screed with applied solid glass beads.
- The removal of all superseded road markings within the site boundary shall be carried out to the satisfaction of the engineer.
- All road markings are subject to the approval of a representative of National Roads Authority at the time of application.
- Road Markings:**
1. DIAGRAM RRM 017:- Stop Line - 200mm wide continuous line. Colour white.
  2. DIAGRAM M 114:- Worded STOP marking - 160mm high. Colour white.
  3. DIAGRAM RRM 027:- Edge of carriageway Line - 150mm wide continuous line. Colour white.
  4. DIAGRAM RRM 021:- Figure 7.16 Hatched Marking - 2 no. 100mm continuous boundary lines, 150mm hatching lines spaced at 3000mm apart. Colour white.
  5. DIAGRAM RRM 002B: Centre Line - 100mm wide line: 3000mm long mark, 3000mm long gap. Colour white.
  6. DIAGRAM RRM 002D: Hazard Warning Line - 100mm wide line: 3000mm long mark, 100mm long gap. Colour white.
  7. DIAGRAM RRM 003A: Centre Line for vehicle proceeding in the same direction - 100mm wide line: 4000mm long mark, 8000mm long gap. Colour white.
  8. DIAGRAM RRM 003B: Centre Line for vehicle proceeding in the same direction on approach to junction/roundabout - 100mm wide line: 2000mm long mark, 2000mm long gap. Colour white.
  9. DIAGRAM RRM 001:- Centre Line, 100mm Continuous single line. Colour White
  10. DIAGRAM M 102:- Bifurcation Arrow - 8000mm Long Arrow. Colour white.
  11. DIAGRAM RRM 005:- Lane direction arrow (left) - 3600mm long arrow. Colour White
  12. DIAGRAM RRM 006:- Lane direction arrow (Right) - 3600mm long arrow. Colour White
  13. DIAGRAM RRM 004:- Lane direction arrow (Straight) - 3600mm long arrow. Colour White
  14. DIAGRAM M 124:- Lane direction arrow (Straight and Left) - 3600mm long arrow. Colour White
  15. DIAGRAM M 125:- Lane direction arrow (Straight and Right) - 3600mm long arrow. Colour White
  16. DIAGRAM RPC 002:- Zig Zag Marking - 8 no. 100mm continuous wide lines, 2000mm long, @ 500mm diagonal width. At the end of the Zigzags Markings remote from the crossing, a transverse Terminal Line, 600mm long by 200mm wide, shall be provided.
  17. DIAGRAM M 131:- Pedestrian crossing Line, 2 no. 100mm Continuous single line. Colour White
  18. DIAGRAM RRM 020:- Yellow box marking. Extends across the full width of the carriageway at a road junction; 200mm wide boundary; 150mm wide inner hatch; 2000mm spacing.
  19. DIAGRAM M 115:- Triangular yield marking - 1250mm wide x 3750mm long. Colour white.
  20. DIAGRAM RRM 018:- Yield Line - 1 No. 200mm wide line: 1000mm long mark, 1000mm long gap. Colour white.
  21. DIAGRAM RRM 019:- No Entry Line - 1 No. 200mm wide, continuous line at junction and 1 broken line 200mm wide 1000mm long strip, 1000mm gap with 300mm between the two lines. Colour white.
  22. DIAGRAM RRM 023:- Cycle Centre Line - 100mm wide line: 750mm long mark, 750mm long gap. Colour white.
  23. DIAGRAM M 116:- Cycle symbol - 1 No. 2750mm high x 1700mm wide symbol. Colour white
  24. DIAGRAM RRM 021:- Figure 7.16 Chevron Hatched Marking - 2 no. 100mm continuous boundary lines, 200mm hatching lines spaced at 3000mm apart. Colour white.
  25. DIAGRAM RRM 022:- Cycle Edge Line - 100mm wide continuous line. Colour white.
  26. Zebra Crossing - (RPC 001:- A set of Pedestrian Lines, Transverse Lines, Stripes, and Pedestrian Crossing Beacons together form a Zebra Crossing, where ramped up include Diagram M 112 traffic calming triangle - colour white

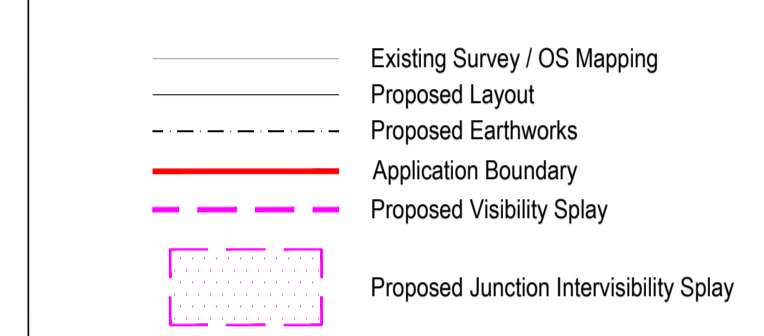
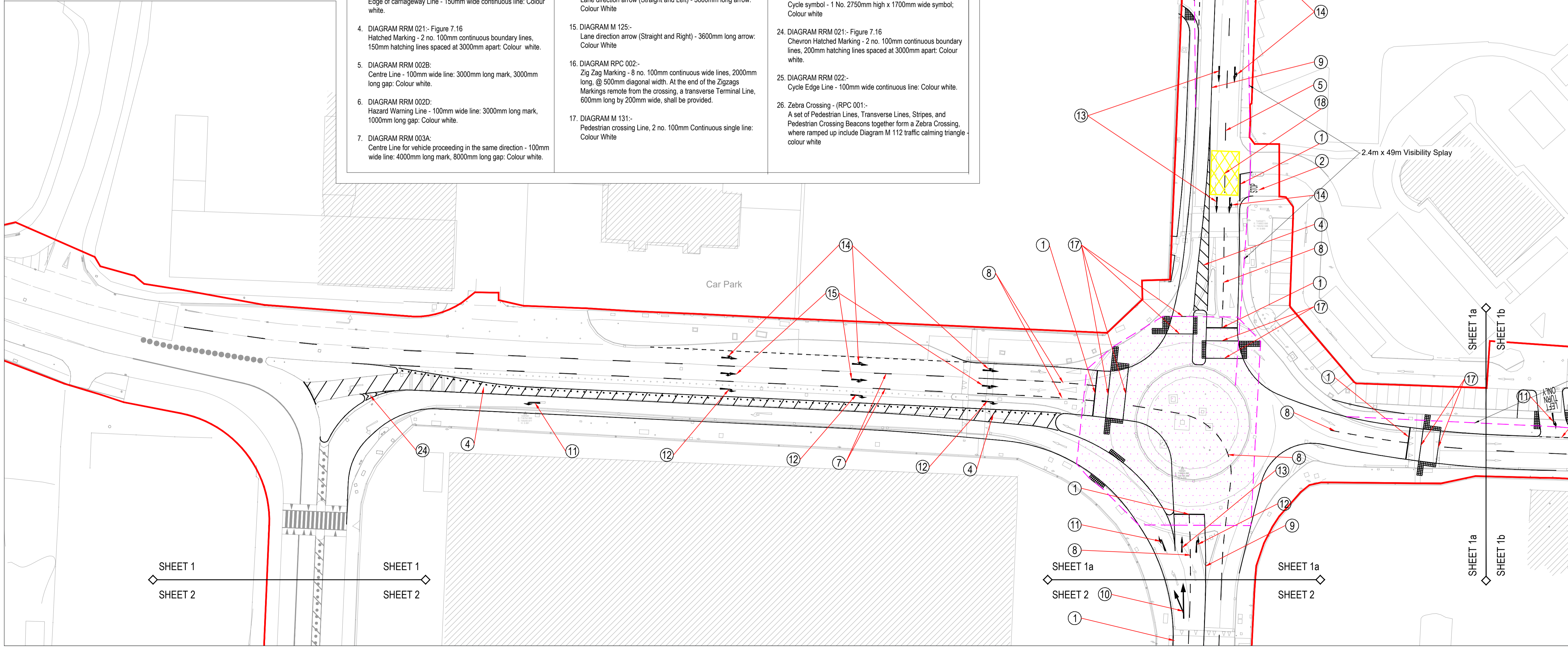

rev	amendments	check	date

Client: **COMHLACHT CHALAFORT ÁTHA CLIAITH DUBLIN PORT COMPANY**

Project: **3FMProject** Bringing Dublin Port To 2040

Title: **Roads & Footways (Northern) - Proposed Road Markings & Visibility Sheet 1**

Project Number IBH0796	Sheet Size A1	Drawing Scale 1:500
---------------------------	------------------	------------------------

Drawing Number: **CP1901\_3FM-RPS\_S26-HMK-NP-DR-HE-100-0001**

Drawn By RD	Status S4	Revision -
----------------	--------------	---------------

Checked By JF	Approved By CDo	Date April 2024
------------------	--------------------	--------------------