

NOTES

1. Verifying Dimensions: The contractor shall verify dimensions against such other drawings or site conditions as pertain to this part of the work.
2. Existing Services: Any information concerning the location of existing services indicated on this drawing is intended for general guidance only. It shall be the responsibility of the contractor to determine and verify the exact horizontal and vertical alignment of all cables, pipes, etc. (both underground and overhead) before work commences.
3. Issue of Drawings: Hard copies, DWG and PDF will form a controlled issue of the drawing. All other formats (JPG, PDF etc.) are deemed to be an uncontrolled issue and any work carried out based on these files is at the recipient's own risk. All of these files, along with the associated drawings, shall be the property of the client and shall be held by the recipient. All of the information contained in these files, including the location of underground services, shall be held by the recipient. The use of unapproved software, and any errors arising when these files are used to aid the recipient's drawing production, or setting out on site.
4. OS Map Sheet No: 3198-13, 3198-14, 3198-15, 3198-18, 3198-19, 3198-20, 3198-23, 3198-24, 3198-25, 3264-03, 3264-04, 3264-05, 3264-08, 3264-09, 3264-10, 3264-12, 3264-14, 3264-15, 3264-18, 3264-19, 3264-20, 3199-11, 3199-12, 3199-13, 3199-14, 3199-15, 3199-16, 3199-17, 3199-18, 3199-19, 3199-21, 3199-22, 3199-23, 3199-24, 3265-01, 3265-02, 3265-03, 3265-04, 3265-05, 3265-07, 3265-08, 3265-09, 3265-10, 3265-11, 3265-12, 3265-16
5. Datum: T.M

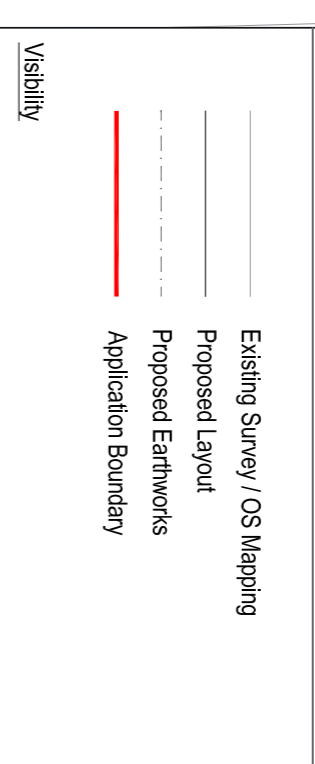

PN2	Revised for planning submission	JF	23/06/24
PN1	Revised for planning amendments	PN	02/10/23
rev	amendments	check	date

Client
CONHLAIGHT CHALAFORT
ATHA CLUATH
DUBLIN PORT COMPANY

Project
3FMProject
Roads & Footways (Southern & SPAR) - Proposed Road Markings and Visibility Sheet 8

Drawing Number	CP1901_3FM-RPS_S26-HMK-XX-DR-FE-100-0008
Drawn By	DM1
Status	S4
Revision	PN2
Checked By	PN
Approved By	CDO
Date	May 2023

Project Information:
 Project Number: IBH0796
 Sheet Size: A1
 Drawing Scale: 1:500

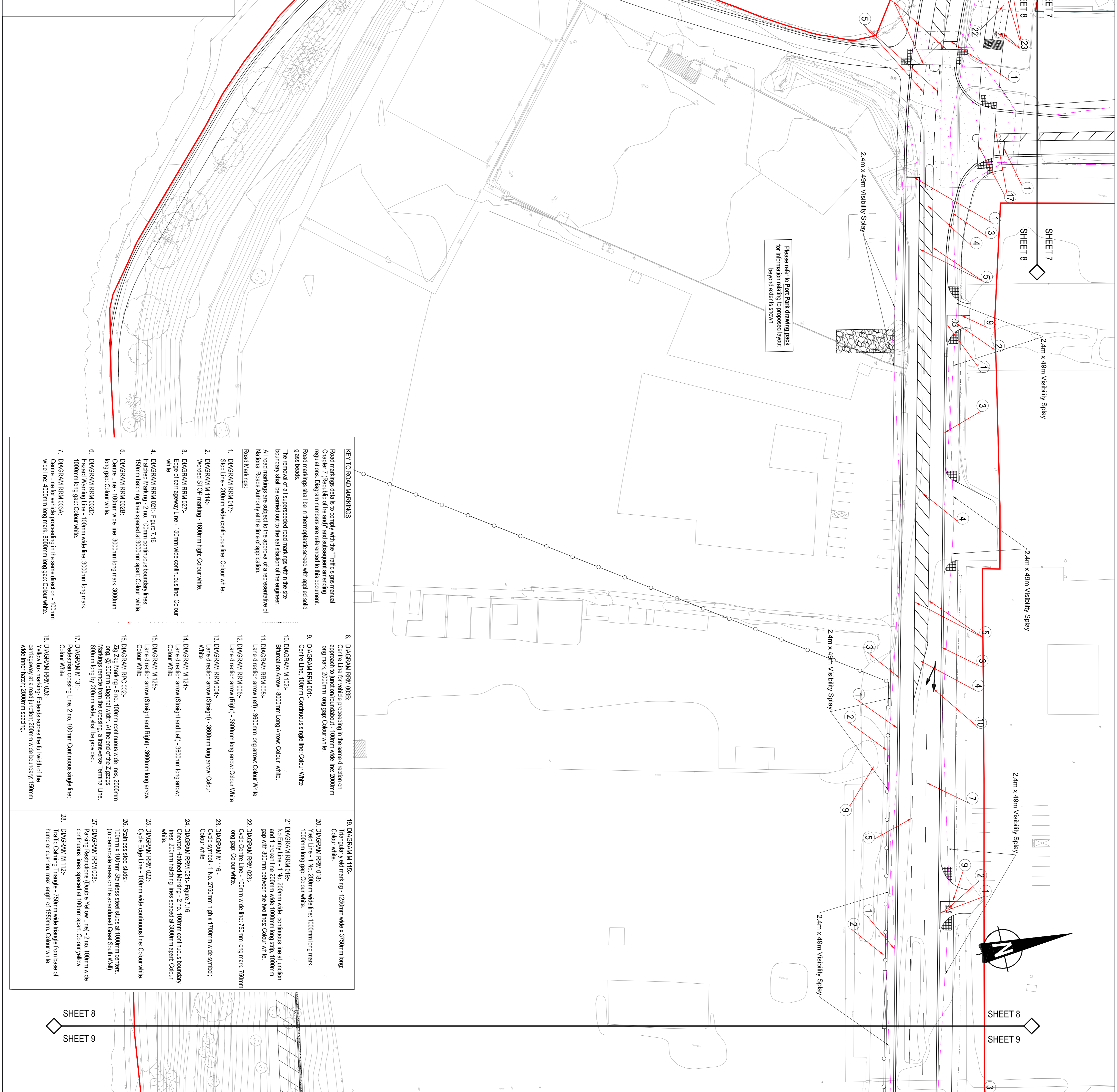
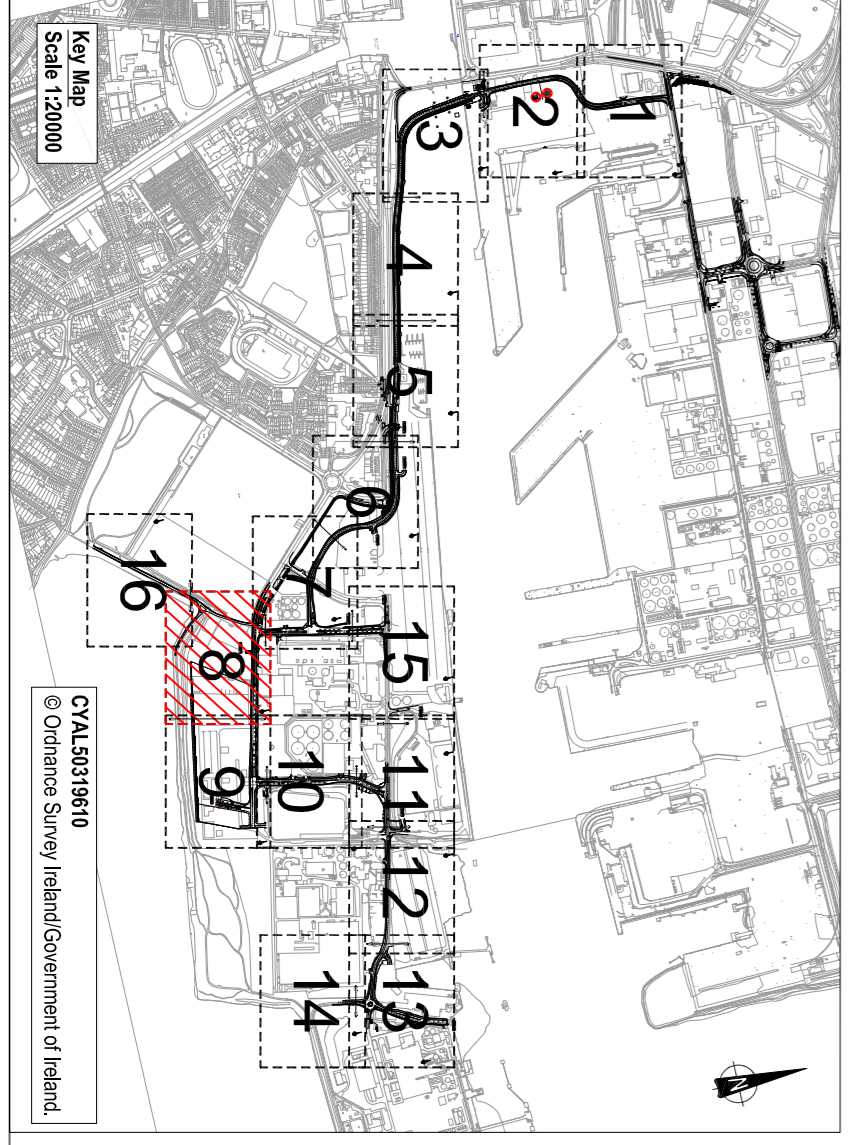

- KEY TO ROAD MARKINGS**
- Road markings details to comply with the Traffic Signs manual Chapter 7 'Rebranding of Ireland' and subsequent amending regulations. Diagram numbers are referenced to this document. Road markings shall be in thermoplastic screed with applied silt glass beads.
- The removal of all superseded road markings within the site boundary shall be carried out to the satisfaction of the engineer. All road markings are subject to the approval of a representative of National Roads Authority at the time of application.
- Road Markings:**
1. DIAGRAM RRM 017:- Stop Line - 200mm wide continuous line. Colour: white.
 2. DIAGRAM M 114:- Worded STOP-marking - 1600mm high. Colour: white.
 3. DIAGRAM RRM 027:- Hazard Warning Line - 150mm wide continuous line. Colour: white.
 4. DIAGRAM RRM 021:- Figure 7.16 Hatched Marking - 2 no. 100mm continuous boundary lines, 150mm hatching lines spaced at 3000mm apart. Colour: white.
 5. DIAGRAM RRM 028:- Centre Line - 100mm wide line. 3000mm long mark. 3000mm long gap. Colour: white.
 6. DIAGRAM RRM 002D:- Hazard Warning Line - 100mm wide line. 3000mm long mark. 1000mm long gap. Colour: white.
 7. DIAGRAM RRM 003A:- Pedestrian crossing line. 2 no. 100mm continuous single line. Colour: white.
 8. DIAGRAM RRM 003B:- Centre line for vehicle proceeding in the same direction on slipway. 200mm long mark. 200mm long gap. Colour: white.
 9. DIAGRAM RRM 001:- Centre Line - 100mm continuous single line. Colour: white.
 10. DIAGRAM M 102:- Bifurcation Arrow - 800mm long arrow. Colour: white.
 11. DIAGRAM RRM 005:- Lane direction arrow (left) - 3000mm long arrow. Colour: white.
 12. DIAGRAM RRM 006:- Lane direction arrow (right) - 3800mm long arrow. Colour: white.
 13. DIAGRAM RRM 004:- Lane direction arrow (straight) - 3800mm long arrow. Colour: white.
 14. DIAGRAM M 126:- Lane direction arrow (straight and left) - 3800mm long arrow. Colour: white.
 15. DIAGRAM M 125:- Lane direction arrow (straight and right) - 3800mm long arrow. Colour: white.
 16. DIAGRAM RRM 002:- Zig-Zag Marking - 4 no. 100mm continuous wide lines, 2000mm long. @ 500mm diagonal width. At the end of the zig-zag markings, a transverse Terminal Line, 600mm long by 200mm wide shall be provided.
 17. DIAGRAM M 131:- Pedestrian crossing line. 2 no. 100mm continuous single line. Colour: white.
 18. DIAGRAM M 020:- Yellow box marking - Extends across the full width of the wide inner hatch. 2000mm spacing.
 19. DIAGRAM M 115:- Triangular yield marking - 1250mm wide x 3750mm long. Colour: white.
 20. DIAGRAM RRM 018:- Yield Line - 1 no. 200mm wide line. 1000mm long mark. 1000mm long gap. Colour: white.
 21. DIAGRAM RRM 019:- 200mm wide continuous line at junction and 1 no. 200mm wide 1000mm long slip. 1000mm gap with 300mm between the two lines. Colour: white.
 22. DIAGRAM RRM 023:- Cycle Centre Line - 100mm wide line. 750mm long mark. 750mm long gap. Colour: white.
 23. DIAGRAM M 116:- Cycle Edge Line - 1 no. 2750mm high x 1700mm wide symbol. Colour: white.
 24. DIAGRAM RRM 021:- Figure 7.16 Chevron Hatched Marking - 2 no. 100mm continuous boundary lines, 200mm hatching lines spaced at 3000mm apart. Colour: white.
 25. DIAGRAM RRM 022:- Cycle Edge Line - 100mm wide continuous line. Colour: white.
 26. Stainless steel studs - 100mm x 100mm stainless steel studs at 1000mm centers (to demarcate areas on the abandoned Great South Wall)
 27. DIAGRAM RRM 008:- Parking Restrictions (Double Yellow Line) - 2 no. 100mm wide continuous lines, spaced at 100mm apart. Colour: yellow.
 28. Traffic Calming Triangle - 750mm wide triangle from base of hump or cushion, max length of 1850mm. Colour: white.