

Key Map  
Scale 1:500

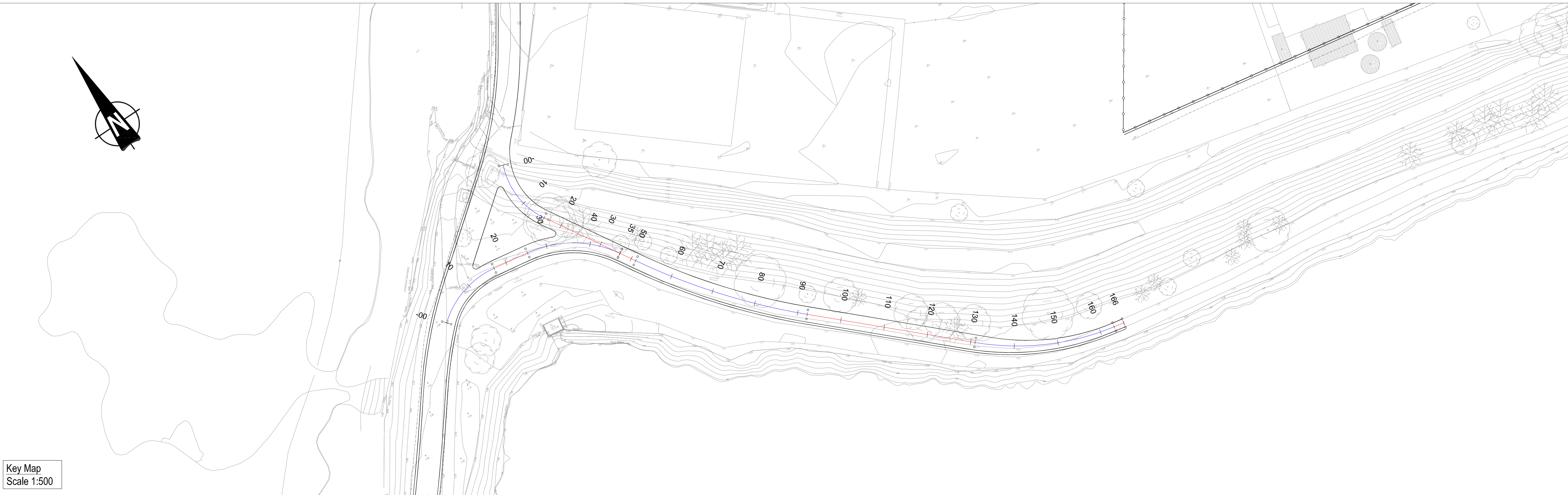

- NOTES**
1. Verifying Dimensions.  
The contractor shall verify dimensions against such other drawings or site conditions as pertain to this part of the work.
  2. Existing Services.  
Any information concerning the location of existing services indicated on this drawing is intended for general guidance only. It shall be the responsibility of the contractor to determine and verify the exact horizontal and vertical alignment of all cables, pipes, etc. (both underground and overhead) before work commences.
  3. Issue of Drawings.  
Hard copies, dwf and pdf will form a controlled issue of the drawing. All other formats (dwg, dxf etc.) are deemed to be an uncontrolled issue and any work carried out based on these files is at the recipient's own risk. RPS will not accept any responsibility for any errors arising from the use of these files, either by human error by the recipient, listing of un-dimensioned measurements, compatibility issues with the recipient's software, and any errors arising when these files are used to aid the recipient's drawing production, or setting out on site.
  4. OS Map Sheet No  
3198-13, 3198-14, 3198-15, 3198-18, 3198-19, 3198-20, 3198-23, 3198-24, 3198-25, 3264-03, 3264-04, 3264-05, 3264-08, 3264-09, 3264-10, 3264-13, 3264-14, 3264-15, 3264-18, 3264-19, 3264-20, 3199-11, 3199-12, 3199-13, 3199-14, 3199-15, 3199-16, 3199-17, 3199-18, 3199-19, 3199-21, 3199-22, 3199-23, 3199-24, 3265-01, 3265-02, 3265-03, 3265-04, 3265-06, 3265-07, 3265-08, 3265-09, 3265-10, 3265-11, 3265-12, 3265-16
  5. Datum: ITM

Plan Key	
	Proposed layout
	Curve alignment
	Straight alignment
	Earthworks
	Existing Survey

Longsection Key	
	Crest / Sag Curves
	Straight alignment
	Existing Survey

5M ATP 2 - LONGSECTION  
SCALE: H 1:500, V 1:100. DATUM: 0.000

5M ATP 3 - LONGSECTION  
SCALE: H 1:500, V 1:100. DATUM: 0.000

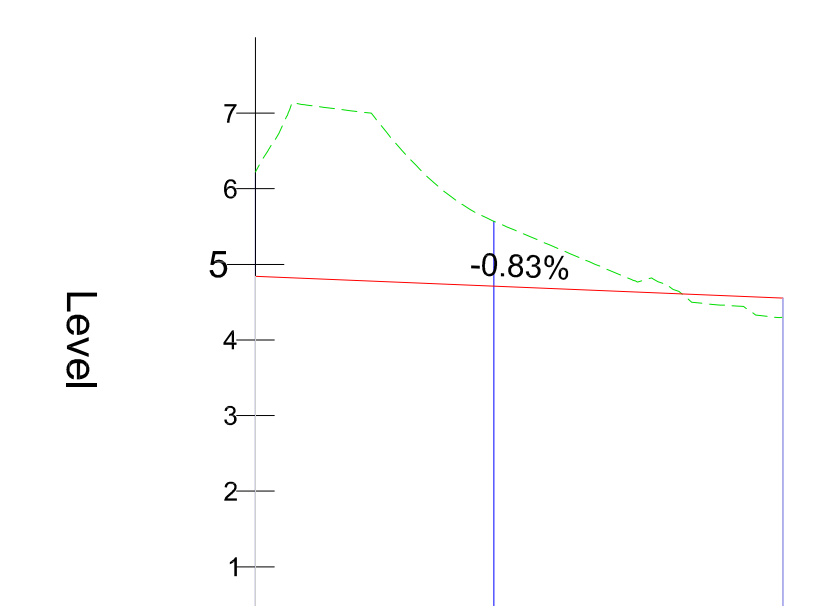
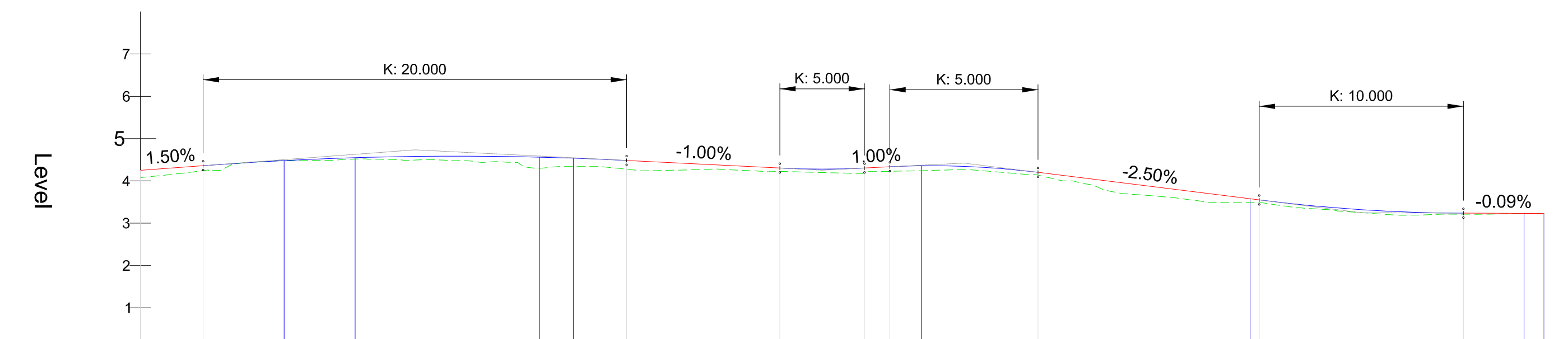

Proposed Levels	4.248	4.396	4.508	4.570	4.583	4.545	4.458	4.358	4.279	4.346	4.316	4.102	3.852	3.602	3.383	3.262	3.234	3.229
Existing Levels	4.094	4.305	4.488	4.503	4.444	4.339	4.240	4.260	4.200	4.233	4.230	4.000	3.637	3.489	3.322	3.190	3.216	3.229
Horizontal Alignment	R: 19.987 L: 16.992		R: 25.000 L: 21.780		L = 3.960		R: 150.000 L: 41.099		G = 1.000% L = 2.992		L = 38.818		R: 58.000 L: 32.330		L = 2.355			
Vertical Alignment	G = 1.500% L = 7.417		R = 2000.000 K = 20.000 L = 50.000		G = -1.000% L = 18.083		R = 500.000 K = 5.000 L = 10.000		R = 500.000 K = 5.000 L = 17.500		G = -2.500% L = 26.107		R = 1000.000 K = 10.000 L = 24.110		G = -0.089% L = 9.507			
Chainage	0.000	10.000	20.000	30.000	40.000	50.000	60.000	70.000	80.000	90.000	100.000	110.000	120.000	130.000	140.000	150.000	160.000	165.715

Proposed Levels	4.842	4.759	4.676	4.593	4.553
Existing Levels	4.842	4.759	4.676	4.593	4.553
Horizontal Alignment	R: 16.750 L: 15.757		L = 19.114		
Vertical Alignment	G = -0.829% L = 34.871				
Chainage	0.000	10.000	20.000	30.000	34.871

P02	Revised for planning submission	CD	27/06/24
P01	Revised for planning	PN	02/10/23
rev	amendments	check	date

**RPS** Elmwood House  
74 Boucher Road  
Belfast  
BT12 6RZ  
T +44 (0) 28 90 667914  
F +44 (0) 28 90 668286  
W www.rpsgroup.com/ireland  
E ireland@rpsgroup.com

Client  
**COMHLACHT CHALAFORT  
ATHA CLIATH  
DUBLIN PORT COMPANY**

Project  
**3FMProject** Bringing Dublin Port To 2040

Title  
**Roads & Footways (Southern & SPAR) -  
Proposed Longsection - ATP  
Sandymount - Sheet 2**

Project Number	Sheet Size	Drawing Scale
IBH0796	A1	As Shown

Drawing Number  
**CP1901\_3FM-RPS\_S26-HML-AT-DR-HE-100-0002**

Drawn By	Status	Revision
DMI	S4	P02

Checked By	Approved By	Date
PN	CDo	May 2023