

Key Map
Scale 1:1000

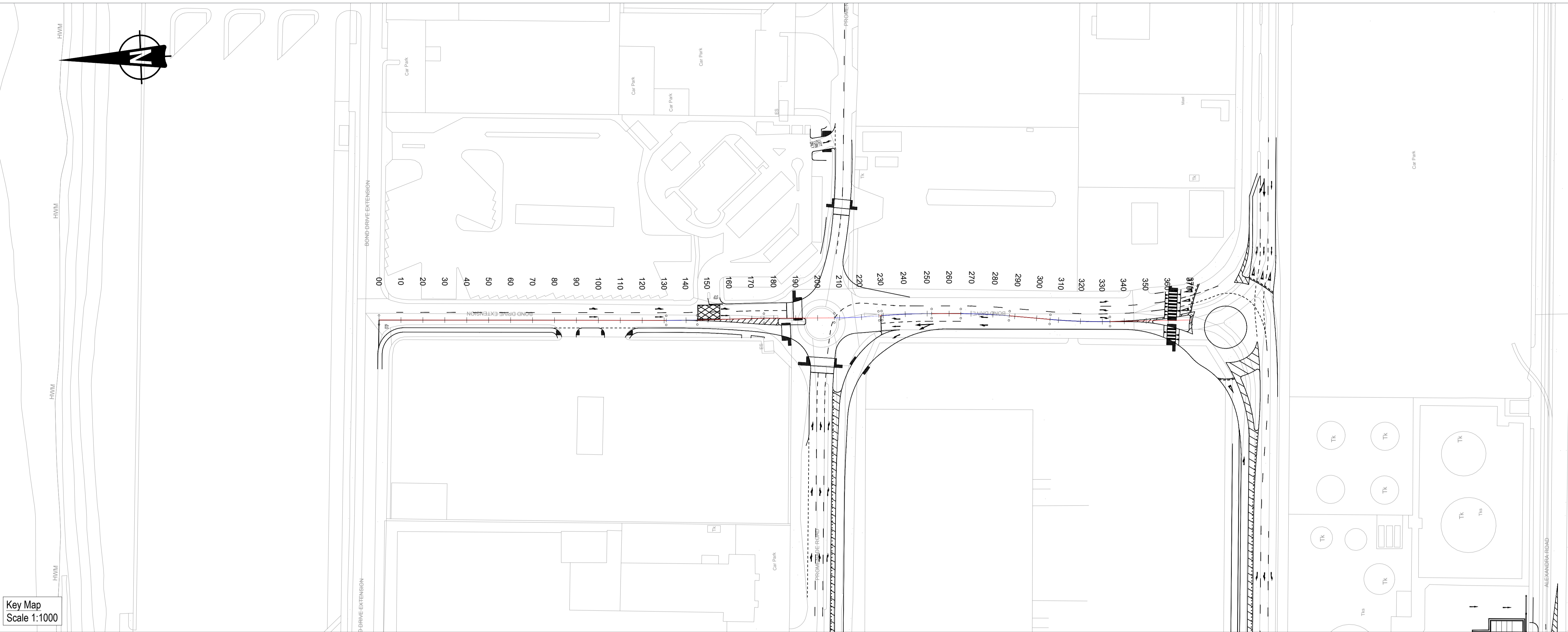

- NOTES**
- Verifying Dimensions.
The contractor shall verify dimensions against such other drawings or site conditions as pertain to this part of the work.
 - Existing Services.
Any information concerning the location of existing services indicated on this drawing is intended for general guidance only. It shall be the responsibility of the contractor to determine and verify the exact horizontal and vertical alignment of all cables, pipes, etc. (both underground and overhead) before work commences.
 - Issue of Drawings.
Hard copies, dwf and pdf will form a controlled issue of the drawing. All other formats (dwg, dxf etc.) are deemed to be an uncontrolled issue and any work carried out based on these files is at the recipient's own risk. RPS will not accept any responsibility for any errors arising from the use of these files, either by human error by the recipient, listing of un-dimensioned measurements, compatibility issues with the recipient's software, and any errors arising when these files are used to aid the recipient's drawing production, or setting out on site.
 - OS Map Sheet No
3198-13, 3198-14, 3198-15, 3198-18, 3198-19, 3198-20, 3198-23, 3198-24, 3198-25, 3264-03, 3264-04, 3264-05, 3264-08, 3264-09, 3264-10, 3264-13, 3264-14, 3264-15, 3264-18, 3264-19, 3264-20, 3199-11, 3199-12, 3199-13, 3199-14, 3199-15, 3199-16, 3199-17, 3199-18, 3199-19, 3199-21, 3199-22, 3199-23, 3199-24, 3265-01, 3265-02, 3265-03, 3265-04, 3265-06, 3265-07, 3265-08, 3265-09, 3265-10, 3265-11, 3265-12, 3265-16
 - Datum. ITM

- Plan Key**
- Proposed layout
 - Curve alignment
 - Straight alignment
 - Earthworks
 - Existing Survey
- Longsection Key**
- Crest / Sag Curves
 - Straight alignment
 - Existing Survey

BOND DRIVE - LONGSECTION
SCALE: H 1:1000, V 1:200. DATUM: 0.000

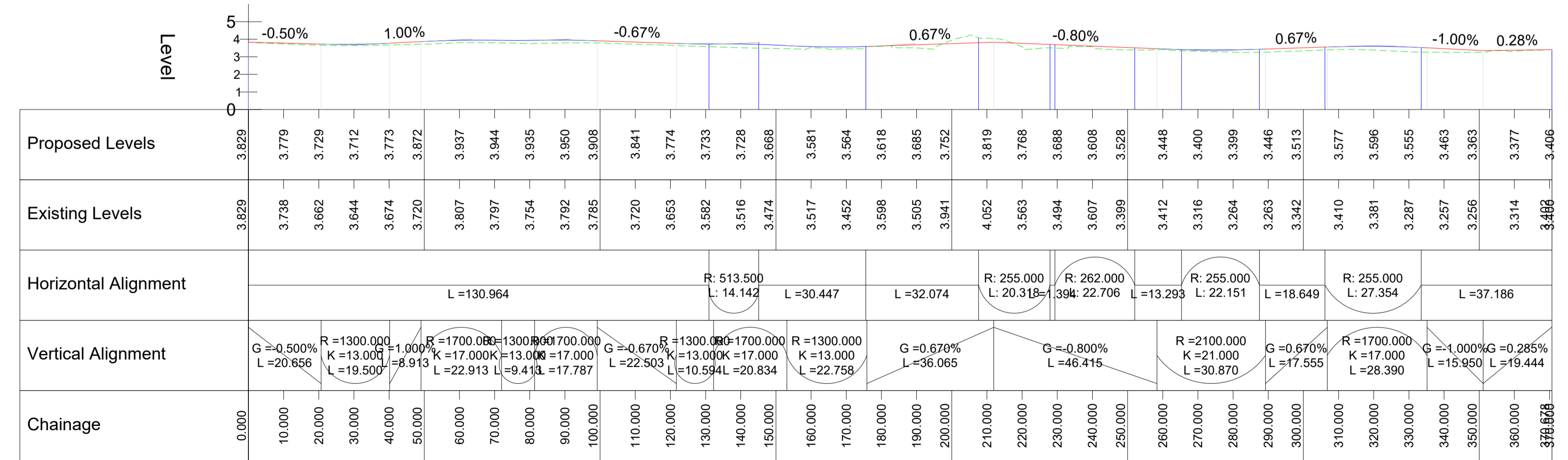

rev	amendments	check	date
-----	------------	-------	------

RPS Elmwood House
74 Boucher Road
Belfast
BT12 6RZ

T +44 (0) 28 90 667914
F +44 (0) 28 90 668286
W www.rpsgroup.com/ireland
E ireland@rpsgroup.com

Client

**COMHLACHT CHALAFORT
ATHA CLIATH
DUBLIN PORT COMPANY**

Project

3FMProject Bridging Dublin Port
To 2040

Title
**Roads & Footways (Northern) -
Proposed Longsection
Bond Drive**

Project Number IBH0796	Sheet Size A1	Drawing Scale As shown
---------------------------	------------------	---------------------------

Drawing Number
CP1901_3FM-RPS_S26-HML-BD-DR-HE-100-0006

Drawn By AM	Status S4	Revision -
----------------	--------------	---------------

Checked By JF	Approved By CD	Date May 2024
------------------	-------------------	------------------