

Key Map
Scale 1:1000

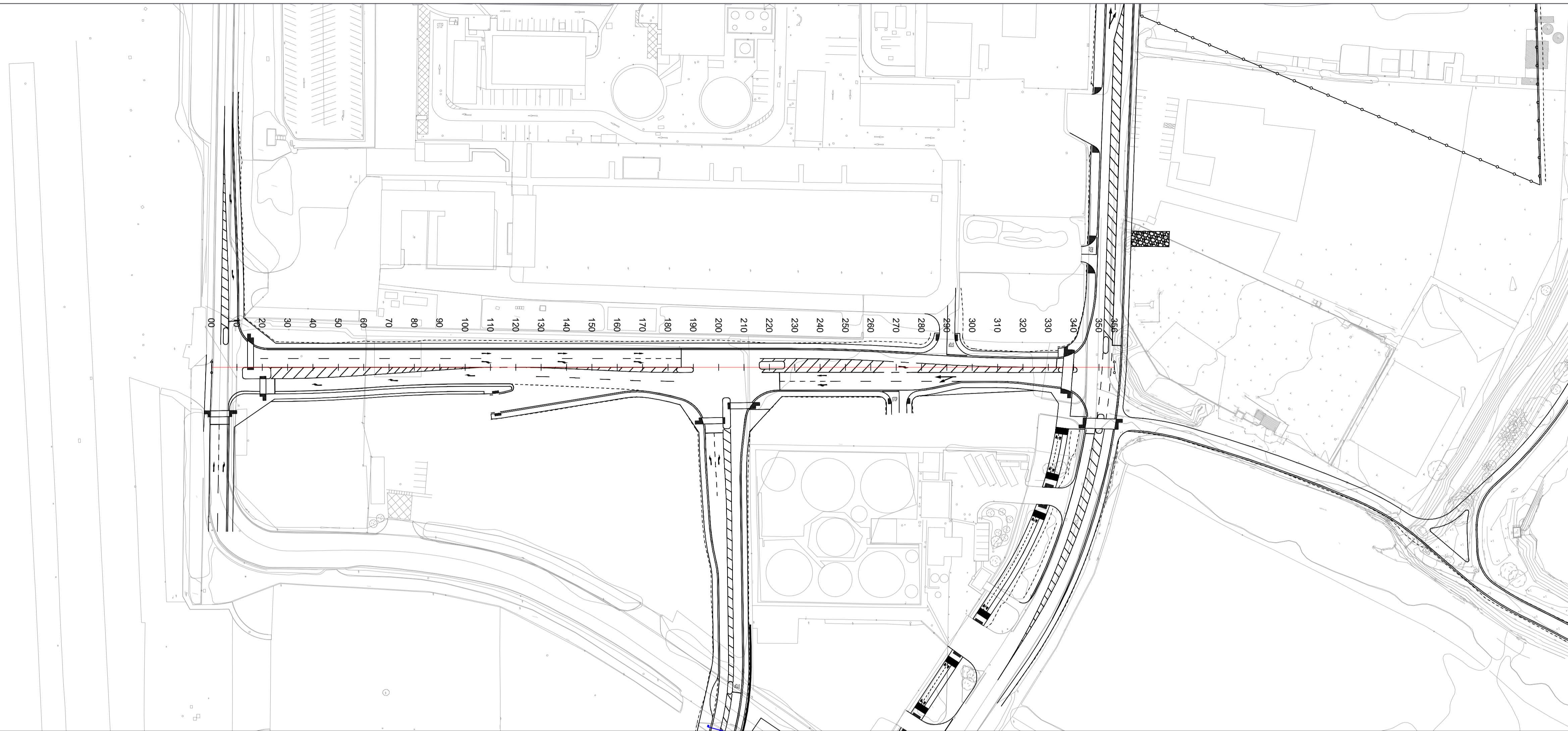

- NOTES**
1. Verifying Dimensions.
The contractor shall verify dimensions against such other drawings or site conditions as pertain to this part of the work.
 2. Existing Services.
Any information concerning the location of existing services indicated on this drawing is intended for general guidance only. It shall be the responsibility of the contractor to determine and verify the exact horizontal and vertical alignment of all cables, pipes, etc. (both underground and overhead) before work commences.
 3. Issue of Drawings.
Hard copies, dwf and pdf will form a controlled issue of the drawing. All other formats (dwg, dxf etc.) are deemed to be an uncontrolled issue and any work carried out based on these files is at the recipient's own risk. RPS will not accept any responsibility for any errors arising from the use of these files, either by human error by the recipient, listing of un-dimensioned measurements, compatibility issues with the recipient's software, and any errors arising when these files are used to aid the recipient's drawing production, or setting out on site.
 4. OS Map Sheet No
3198-13, 3198-14, 3198-15, 3198-16, 3198-17, 3198-18, 3198-19, 3198-20, 3198-21, 3198-22, 3198-23, 3198-24, 3198-25, 3264-03, 3264-04, 3264-05, 3264-06, 3264-07, 3264-08, 3264-09, 3264-10, 3264-11, 3264-12, 3264-13, 3264-14, 3264-15, 3264-16, 3264-17, 3264-18, 3264-19, 3264-20, 3264-21, 3264-22, 3264-23, 3264-24, 3264-25, 3265-01, 3265-02, 3265-03, 3265-04, 3265-05, 3265-06, 3265-07, 3265-08, 3265-09, 3265-10, 3265-11, 3265-12, 3265-16
 5. Datum: ITM

- Plan Key**
- Proposed layout
 - Curve alignment
 - Straight alignment
 - Earthworks
 - Existing Survey
- Longsection Key**
- Crest / Sag Curves
 - Straight alignment
 - Existing Survey

WHITEBANK ROAD - LONGSECTION
SCALE: H 1:1000, V 1:200. DATUM: 0.000

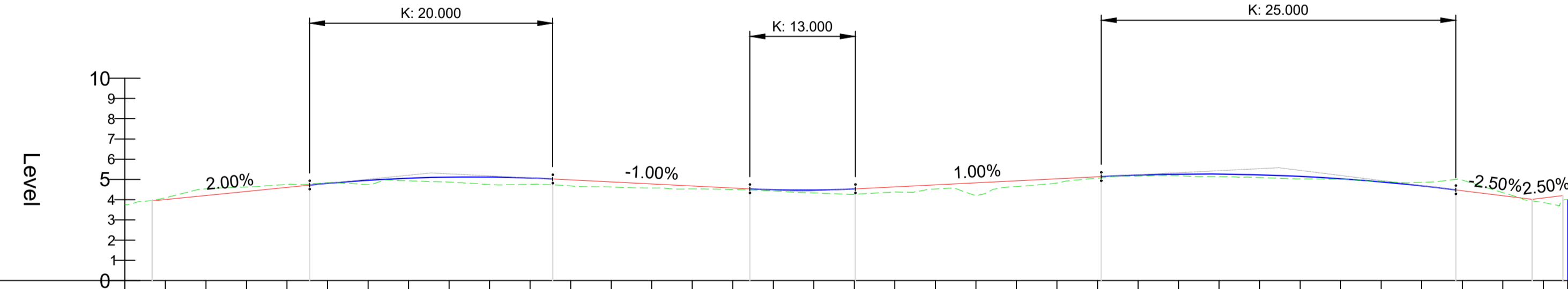

Proposed Levels	4.009	4.209	4.409	4.609	4.804	4.957	5.060	5.113	5.116	5.069	4.977	4.877	4.777	4.677	4.577	4.490	4.472	4.532	4.632	4.732	4.832	4.932	5.032	5.132	5.216	5.260	5.263	5.227	5.151	5.034	4.878	4.682	4.446	4.196	4.083	4.000	
Existing Levels	3.745	4.094	4.537	4.626	4.754	4.839	4.744	4.934	4.868	4.749	4.760	4.679	4.630	4.573	4.530	4.500	4.432	4.334	4.271	4.380	4.527	4.192	4.650	4.826	5.063	5.168	5.162	5.137	5.093	5.025	5.010	4.899	4.858	4.965	4.352	3.860	4.000
Horizontal Alignment	L = 356.055																																				
Vertical Alignment	G = 2.000% L = 38.860		R = 2000.000 K = 20.000 L = 60.000				G = -1.000% L = 48.644				R = 1300.000 K = 13.000 L = 26.000				G = 1.000% L = 60.700				R = 2500.000 K = 25.000 L = 87.500				G = -2.500% L = 18.824			G = 2.500% L = 7.557											
Chainage	0.000	10.000	20.000	30.000	40.000	50.000	60.000	70.000	80.000	90.000	100.000	110.000	120.000	130.000	140.000	150.000	160.000	170.000	180.000	190.000	200.000	210.000	220.000	230.000	240.000	250.000	260.000	270.000	280.000	290.000	300.000	310.000	320.000	330.000	340.000	350.000	355.055

P02	Revised for planning submission	CD	27/06/24
P01	Revised for planning	PN	02/10/23
rev	amendments	check	date

rps Elmwood House
74 Boucher Road
Belfast
BT12 6RZ

T +44 (0) 28 90 667914
F +44 (0) 28 90 668286
W www.rpsgroup.com/ireland
E ireland@rpsgroup.com

Client

**COMHLACHT CHALAFORT
ATHA CLIATH
DUBLIN PORT COMPANY**

Project

3FMProject Bringing Dublin Port To 2040

Title
Roads & Footways (Southern & SPAR) - Proposed Whitebank Road Longsection Sheet 1

Project Number IBH0796	Sheet Size A1	Drawing Scale As Shown
---------------------------	------------------	---------------------------

Drawing Number
CP1901_3FM-RPS_S26-HML-WB-DR-HE-100-0001

Drawn By DMI	Status S4	Revision P02
-----------------	--------------	------------------------

Checked By PN	Approved By CDo	Date Dec 2022
------------------	--------------------	------------------