

--- SITE BOUNDARY TO MARITIME VILLAGE

LEGEND: HARD LANDSCAPE, EXISTING

EXISTING CONCRETE SURFACE

LEGEND: HARD LANDSCAPE, PROPOSED

- COBBLE STONE
- CONCRETE FOOTPATH
- ACTIVE TRAVEL SURFACE (COLOUR TO MATCH DARMODY ARCHITECTURE COLOUR I.E. STANDARD CYCLE WAY COLOUR)
- NATURAL STONE TYPE 1
- NATURAL STONE TYPE 2 (COBBLE)
- NATURAL STONE TYPE 3 (FEATURE SLABS AND EDGING)
- TACTILE SLABS
- NEW LINE OF METAL RAILINGS

LEGEND: SOFT LANDSCAPE, PROPOSED

- MIXED PLANTING
- LOW GROUNDCOVER
- ATR PLANTING
- NEW TREES (tags 3.1, 3.2, 3.3, 3.4 etc.) (Trees not tagged, represent new trees in Active Travel Route pack)
- EXISTING GREEN SPACE (NO WORKS)
- EXISTING TREES
- EXISTING SHRUBS TO BE RETAINED

PIGION HOUSE RD:		PLANTS	SIZE	QTY.
Trees:	1.1	Tilia 'Greenopt'	20-25cm (WRB)	13
	1.2	Crataegus monogyna 'Spring'	20-25cm (WRB)	10
Groundcover:	1.3	3Mtr Design by Nature willowherb mix		7g/sgm
		With 50% bent and fescue grass seed & Bulbs		
		Leucosium actívum	bulb	50
		Conocis tomasianum	bulb	50
		Scilla sibirica	bulb	50
		Narcissus poeticus	bulb	50
		Hyacinthoides non-scriptus	bulb	50
		Allium hollandicum	bulb	25
		Camassia leichlini 'Alba'	bulb	25

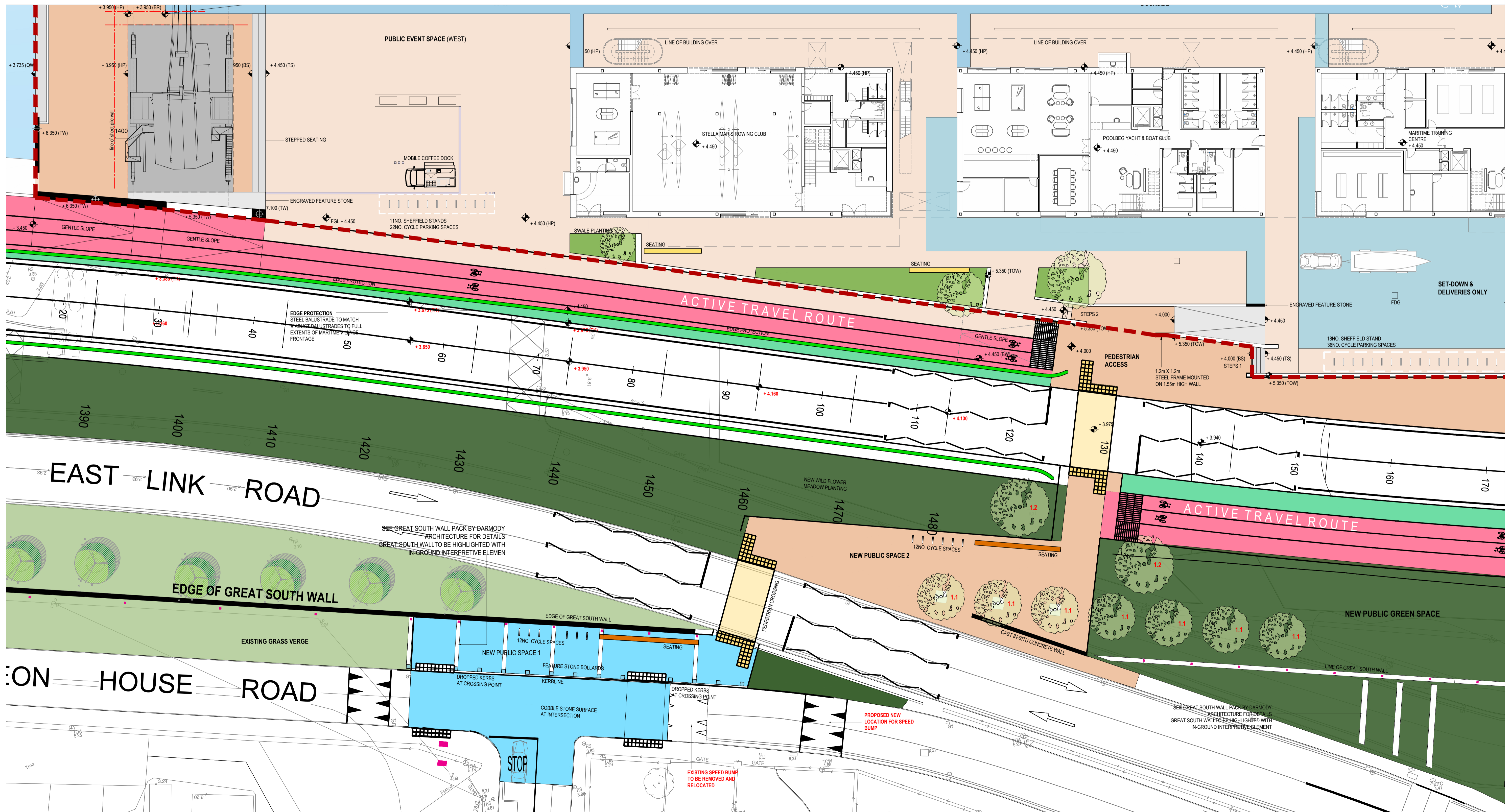

PLANNING

figured dimensions only to be used do not scale from drawing all dimensions to be checked on site with the architect to be notified of any discrepancies. all copyright reserved

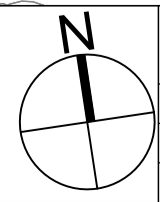

PROJECT	3FM-PROJECT
CLIENT	DUBLIN-PORT-COMPANY
Job No.	2212
Scale	1:200@A1

Dwg. Title	ACTIVE-TRAVEL-ROUTE: PROPOSED-LANDSCAPE-PLANSTOP-POINT-B
DRN/CKD	FM/JS
Dwg. No.	33-P-200
Date	28.02.23

TTT - thirtythreetrees	77 MERRION SQUARE, DUBLIN 2	+ 353.1.507 9161
telephone		office@thirtythreetrees.com
e-mail		www.thirtythreetrees.com
website		

ISSUE	REVISIONS
11/07/2024	ISSUED FOR PLANNING
Date	Description

REVISIONS	Date	By	Description
A			